

# Pz.Kpfw.IV Ausf. H Vomag

## EARLY PROD. MAY 1943

35298

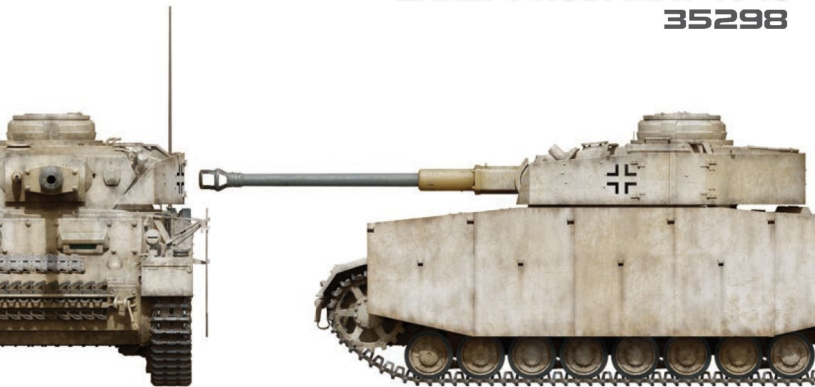

### GENERAL INSTRUCTION

- HIGHLY DETAILED MODEL
- DRIVER COMPARTMENT INTERIOR ACCURATELY REPRESENTED
- FULLY DETAILED FIGHTING COMPARTMENT INTERIOR
- HIGHLY DETAILED INTERIOR OF TURRET

- ALL HATCHES CAN BE POSED OPEN & CLOSED
- FULL AMMUNITION INCLUDED
- ENGINE INCLUDED
- WORKABLE TRACKS INCLUDED
- CLEAR PLASTIC PARTS INCLUDED
- PHOTO-ETCHED PARTS INCLUDED
- DECAL SHEET FOR 3 OPTIONS

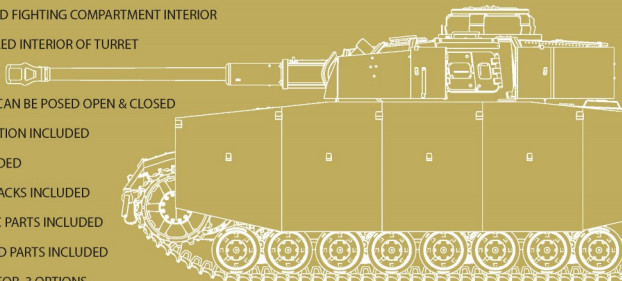

# Pz.Kpfw.IV Ausf. H Vomag

## EARLY PROD. MAY 1943



SCALE  
**1:35**

**1** PAINTING GUIDE 1 Pz.Rgt. 35, 4 Pz.Div. Soviet Union, Orel Direction, August 1943

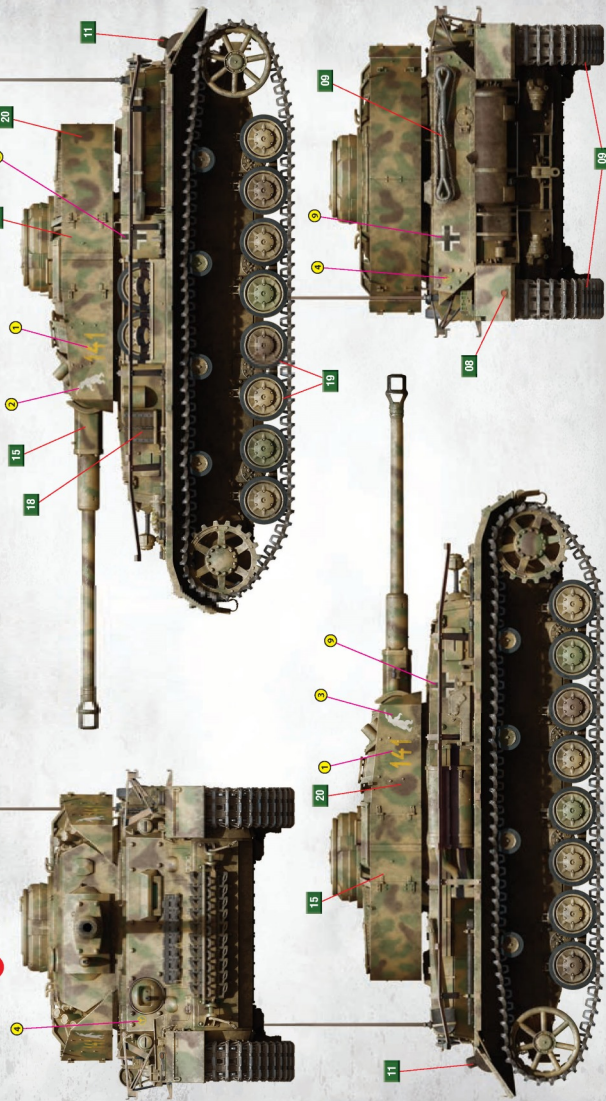

**ATTENTION**  
Ne pas utiliser de colle ou de peinture à proximité d'une flamme nue, et éviter la pièce de temps en temps.  
Pour retirer les pièces hors du cadrn, utiliser des ciseaux spéciaux pour marquer le plastique en esche avec un cutter ou une lime.  
Vor la fin de cette colonne pour la signification des symboles.  
Après l'assemblage peut rester des pièces inutilisées.

**ZU BEACHTUNG!**  
Kleber und Farbe nicht nahe von offenem Feuer verwenden und das Fenster von Zeit zu Zeit zur Belüftung öffnen.  
Zum Abschneiden der Teile vom Werbustück eine Modellerschere verwenden und die überstehenden Plastikteile mit einem Messer oder einer Feile beseitigen.  
Die Bedeutung der Symbols finden Sie unten in dieser Spalte.  
Nach dem Zusammenbau des Modells, können einzelne Teile übrig bleiben

**УВАГА**  
При використанні клею та фарб всі роботи проводити подаль від джерел вогню у приміщенні, що добре провітрюється.  
Деталі відкривати від літників ножем або шпатель ручними інструментами. Зачистити обрив і места з'єднань наждачкою та надкочного паперу. Будування моделі виконувати з'єдну і саново. Для зручності побудови кожна деталь позначена номером.  
Після озавання можуть залишитися невикористані деталі.

**ATTENZIONE**  
Non usare colla e vernice vicino a fiamme esposte, e aprire le finestre di tanto in tanto per cambiare l'aria. Quando si staccano parti del cartello, usare forbici da modellismo e eliminare la plastica in eccesso con un coltello o una lima. Vedere in fondo a questa colonna per il signif. Dopo l'assemblaggio possono rimanere parti inutilizzate.

**ВНИМАНИЕ**  
При использовании клея и красок все работы производить в проветриваемом помещении вдали от источников огня.  
Детали отделять от литников ножом или другими режущими инструментами. Зачистить обрыв и места с'єднанья наждачкой и наждачной бумагой. Сборку моделей производить согласно схеме сборки.  
Для удобства сборки каждая деталь обозначена номером.  
После сборки набора могут остаться неиспользованные детали.

**CAUTION**  
When you use glue or paint, do not use near open flame, and use in well ventilated room. When you take parts off from the runner frame, use modeling scissors or cutter.  
See the bottom of this column for the meaning of symbols.  
Extra details can remain after assembling of the kit.

## PARTS

### Ai x4

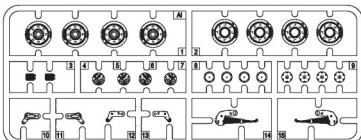

### Eb

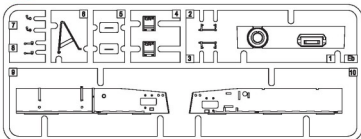

### Kc (Clear parts)

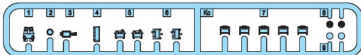

### Decol

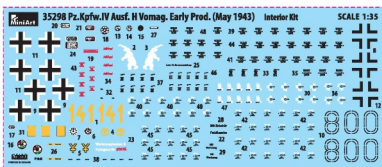

### PEb parts

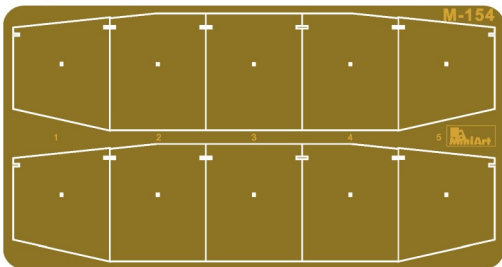

### PEa parts

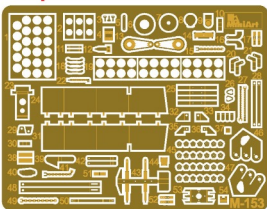

### Cd

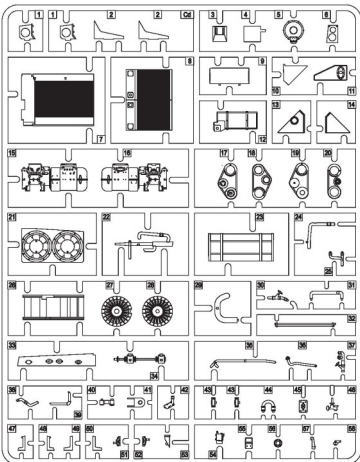

### Ke

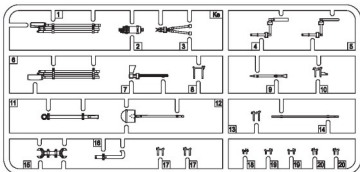



MAKÉ DVA  
3 TEILE FERTIGEN  
ESTRECI UZ 3 PIECES  
FARE CUIE PEZZE:  
TUE 3 PC  
COR 3 BT  
ГЛАВНОЕ ДВА ПЬЕСА  
КЛЯСЬЦЬ ПАВБ



DO NOT CEMENT  
NICHT KLEBEN  
NE PAS COLLER  
NON INCOLLARE  
ELEMMA  
LIMMAJU  
НЕ ПОСКОЛЮВАТЬ КЛЕЯ  
НЕ КЛЕИТИ



OPTIONAL  
NACH BELIEBEN  
FACILITATI  
FACOLTATIVO  
FACILITATIVNO  
VALIKOVANIMANEN  
VALIKAR  
BAYPANTY  
BAYPANTY



OPEN HOLE  
OFFENEN  
FARE UN TROU  
FORO APERTO  
ACQUA NERA  
OPPAHALET  
QESHKAT OTRPUSHITE  
SPROBITI OTRP



REMOVE  
ENTFERNEN  
RETRAIRE  
SEPARARE  
POSTI  
ALLAGNAR  
OTKRYVATY  
BYPYRATY



REND  
BITS BIEGEN  
PLIER LES, VOUS PLIAT  
PIEGARE  
PLATA  
BOCCA  
BYPYRATY  
BYPYRATY



SCRATCH-BUILD  
AM MISTEN ZU MACHEN  
FAIRE LE PLUS  
RENDETI  
TUE FISE  
COR DIO SULLI  
QESHKAT SAKARAF  
SPROBITI SAKARAF

## PARTS

### Ba x2

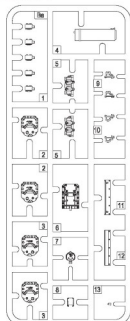

### Bd x2

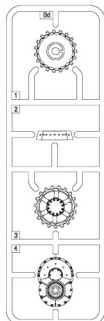

### Bex x2

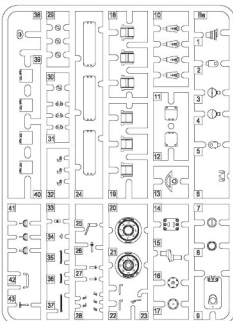

### Bc x2

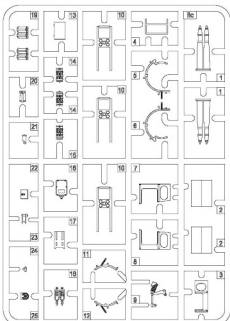

### Da

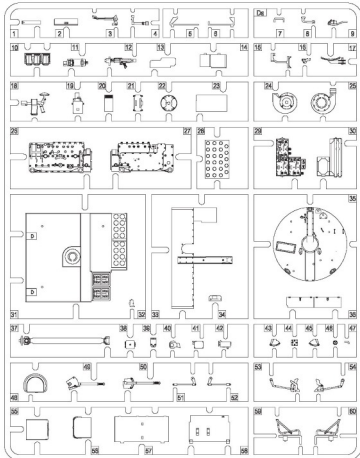

### Db

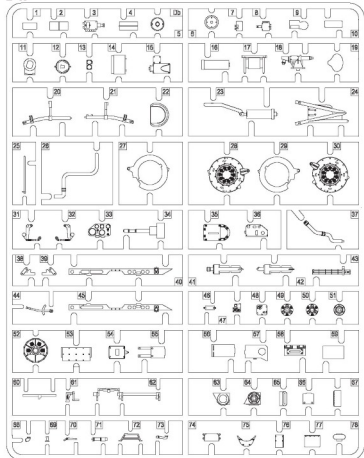

### Lg

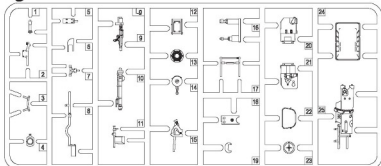

### Ld

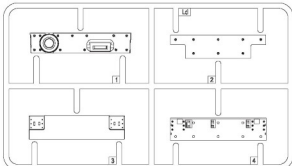

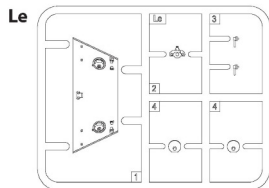
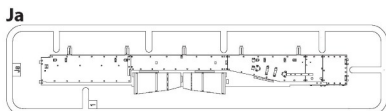
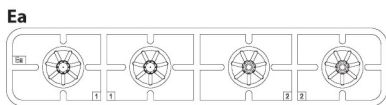
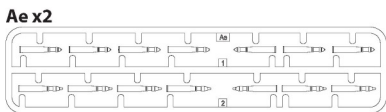
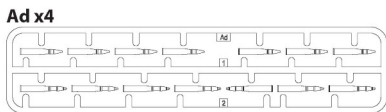
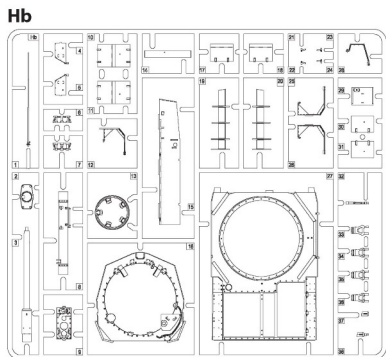
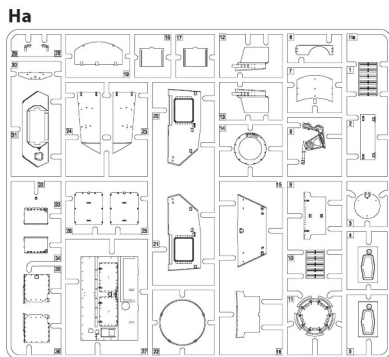
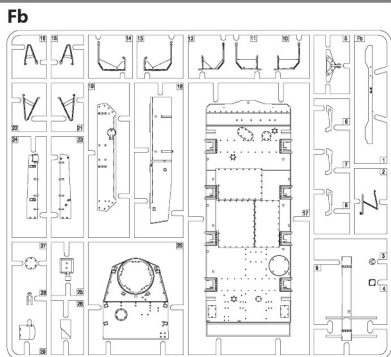
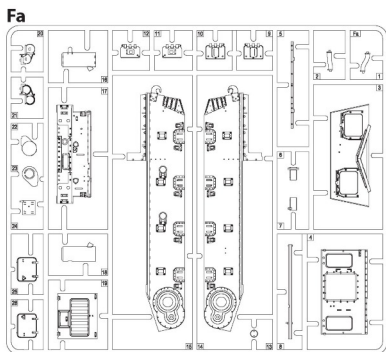

Ed

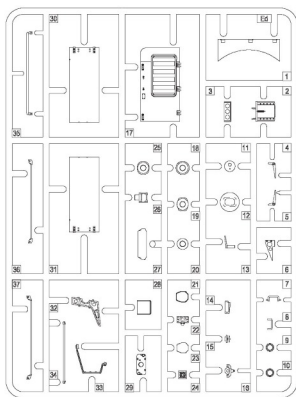

Jb

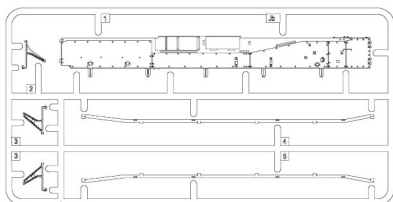

Jc

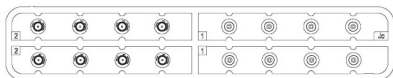

Ca

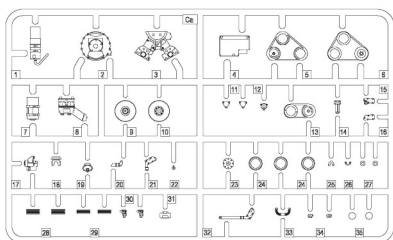

Ec

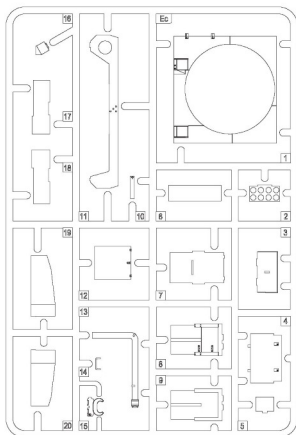

Cb

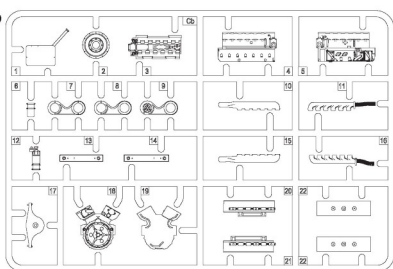

Jd

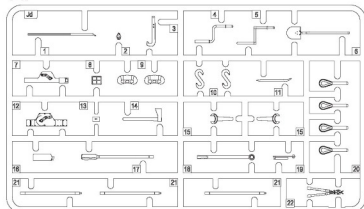

Tracks x22

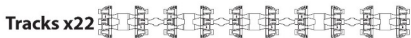

Af x4

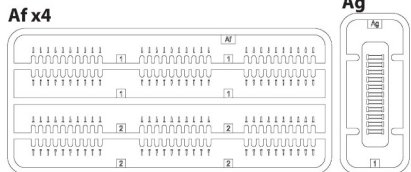

Ag

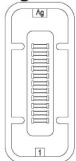

1

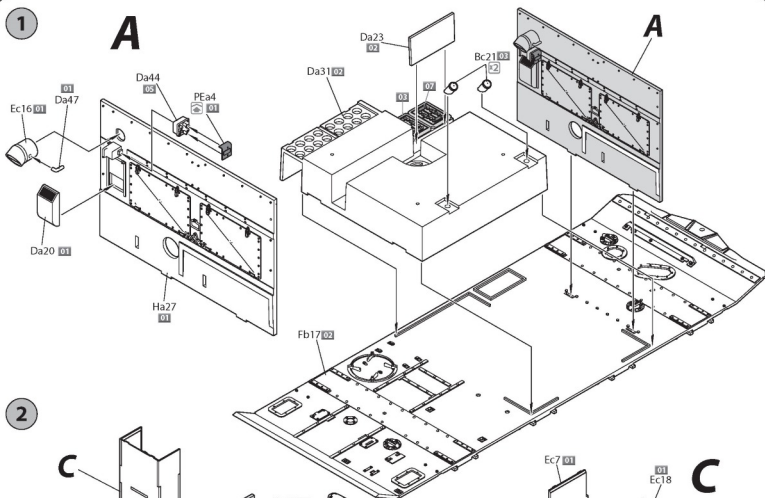
**A**

2

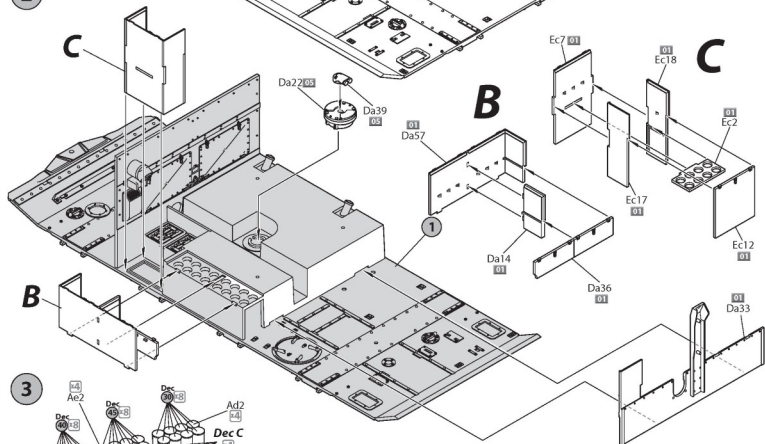

3

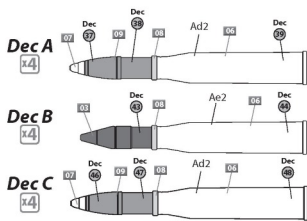
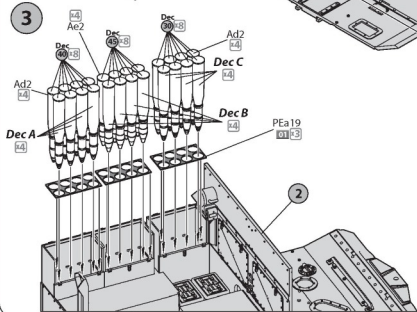

7

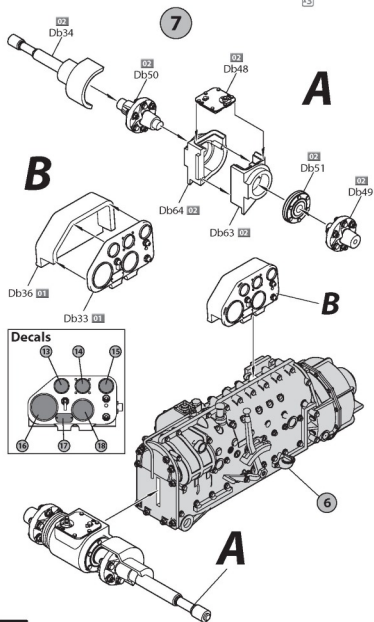
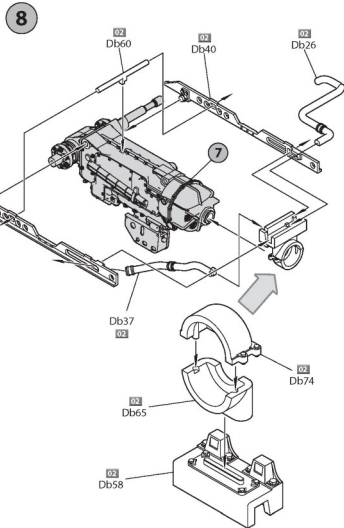
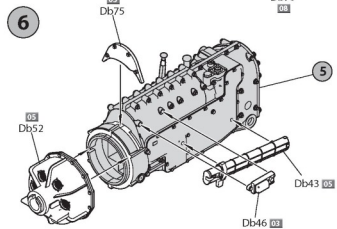
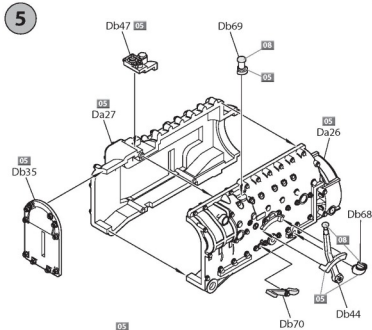
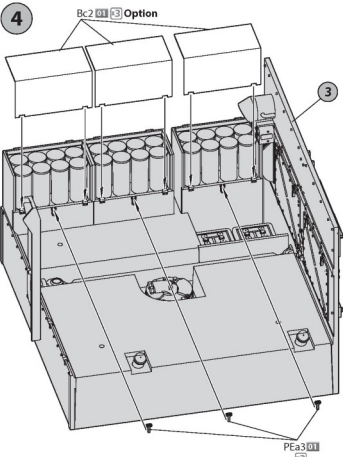



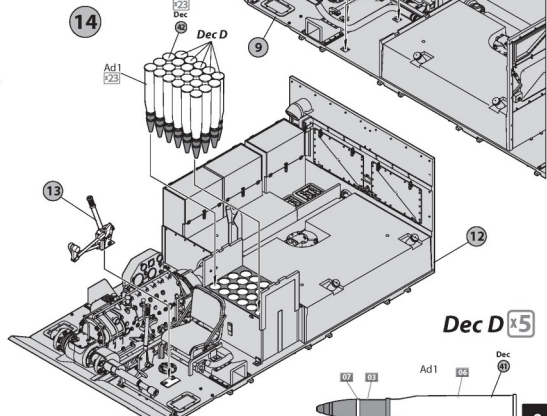
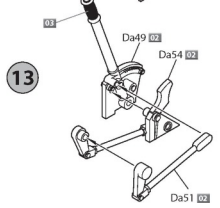
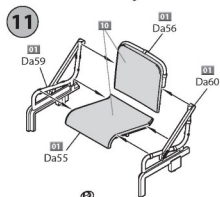
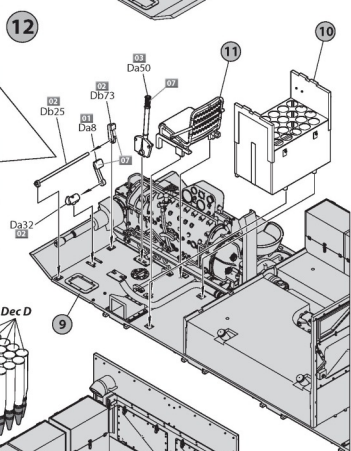
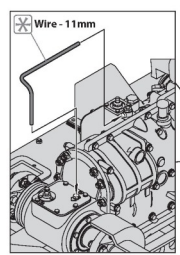
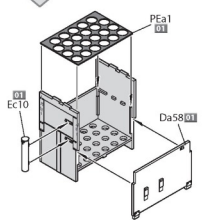
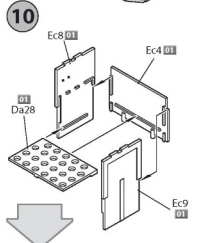
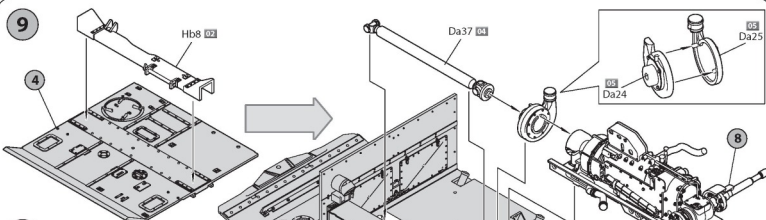

**Dec D x5**

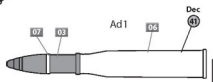

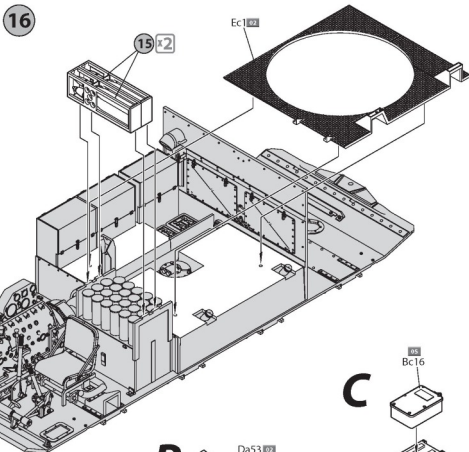
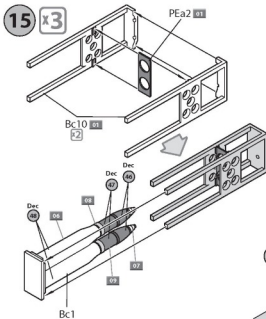

**15** Option See step 115

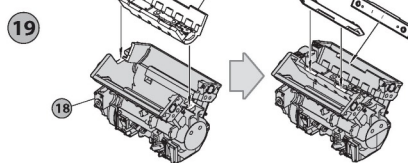
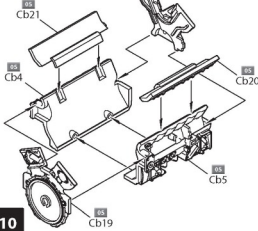
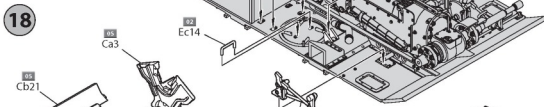
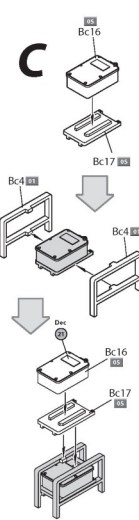
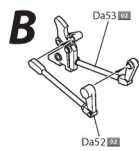
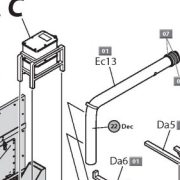

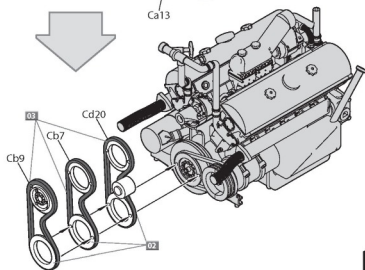
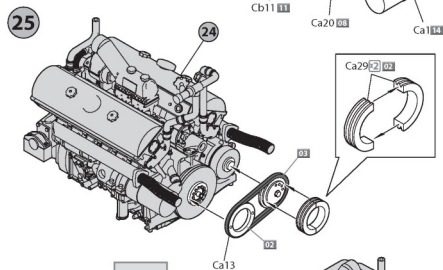
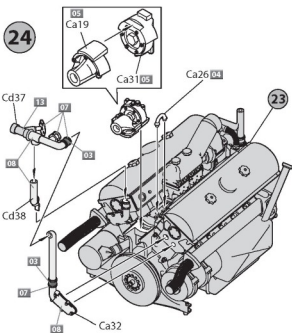
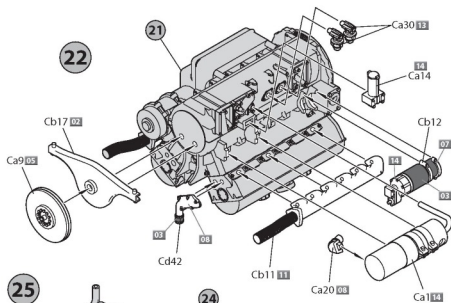
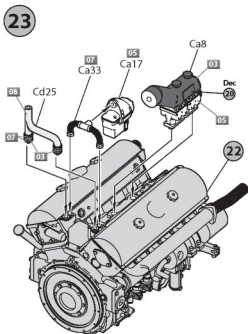
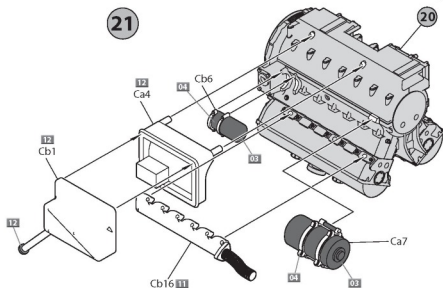
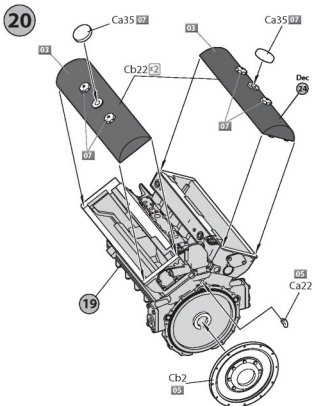

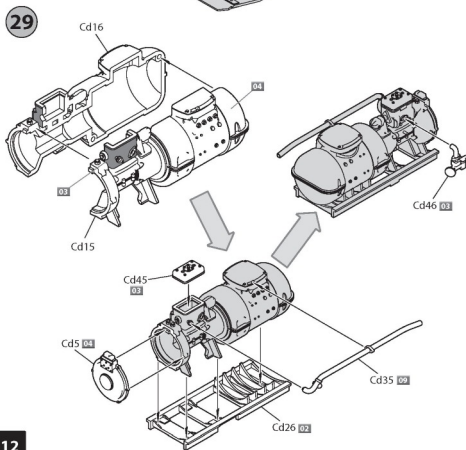
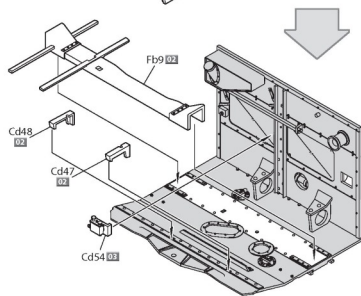
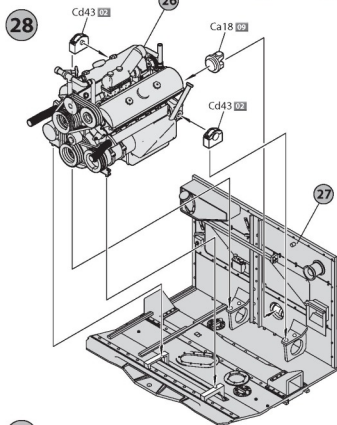
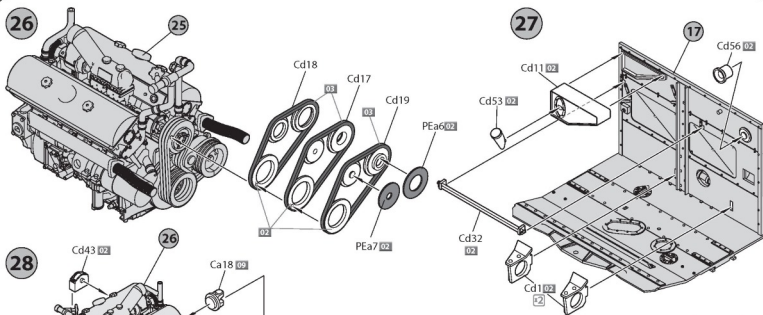

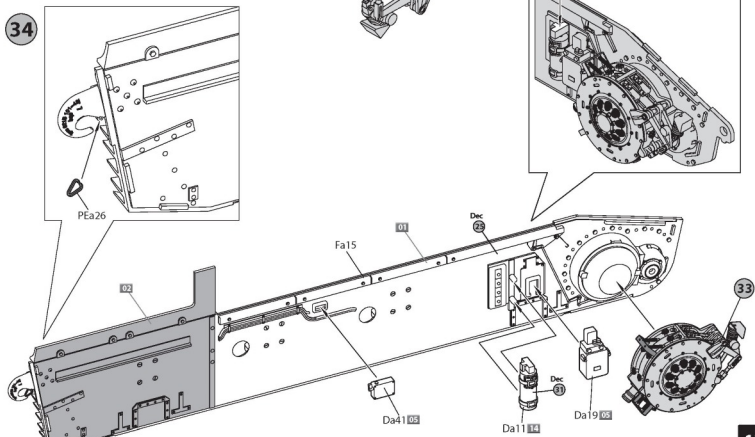
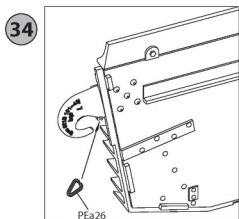
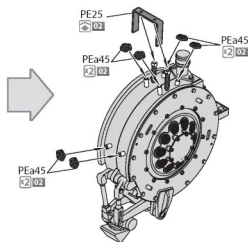
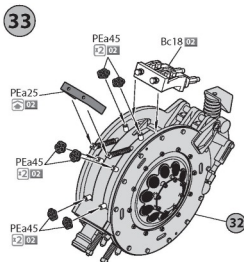
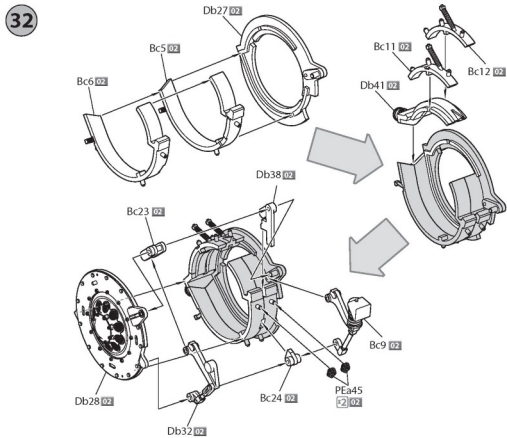
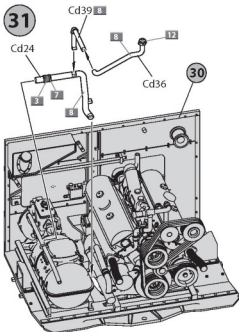

35

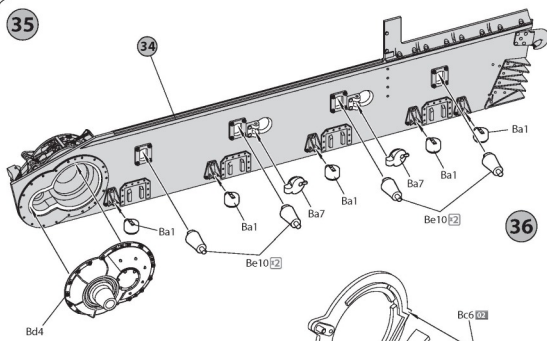

36

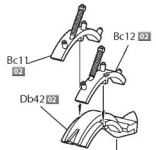

37

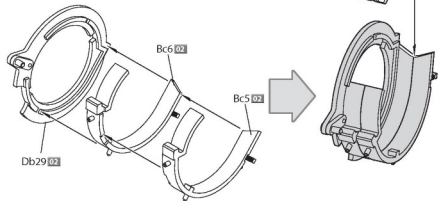

38

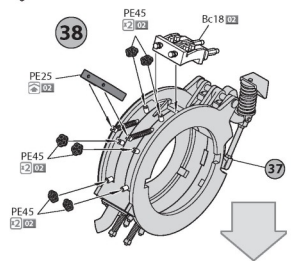
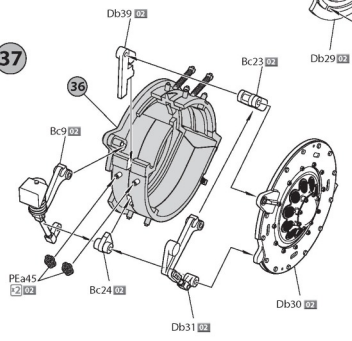

39

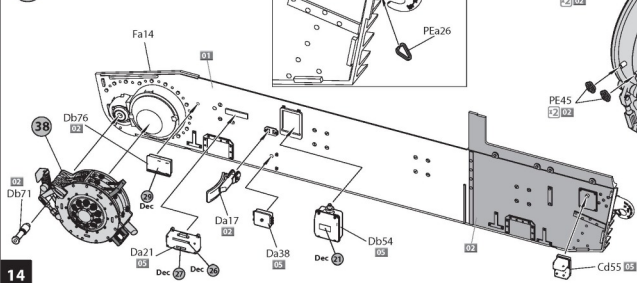
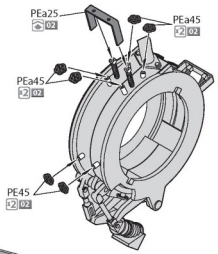

40

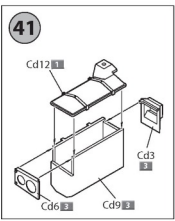
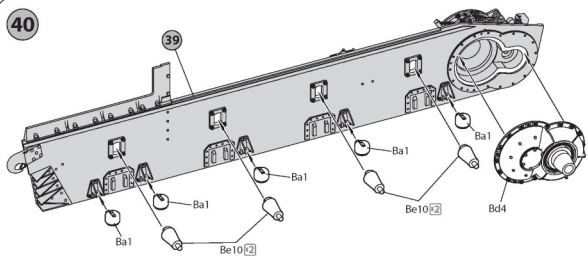

42

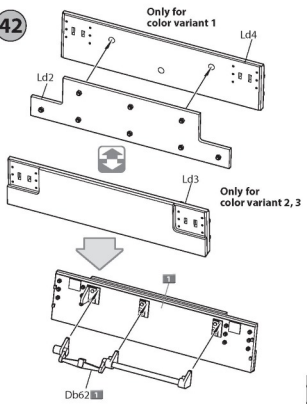

43

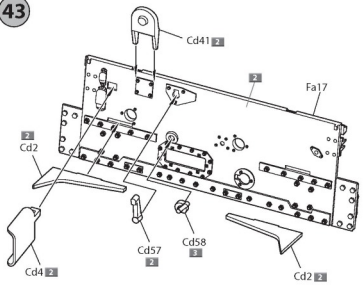

44

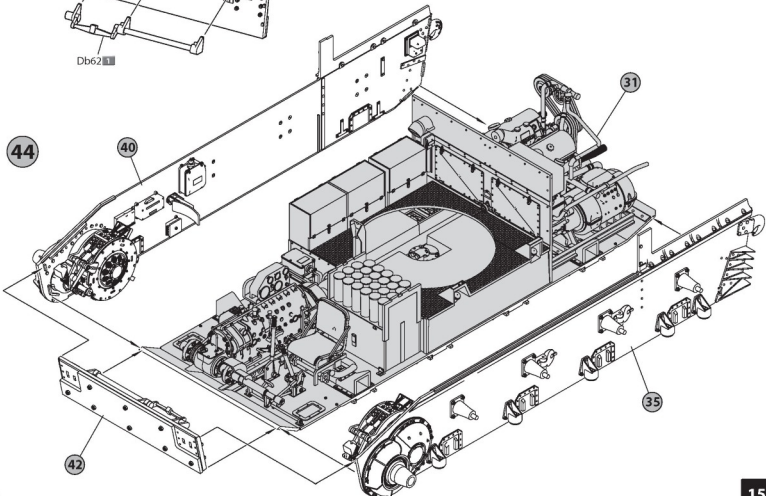

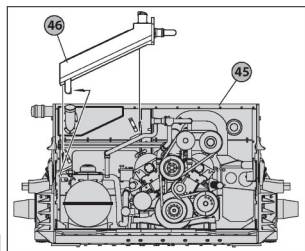
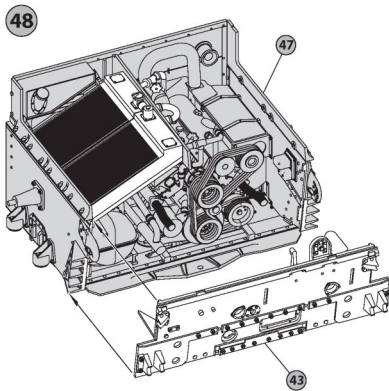
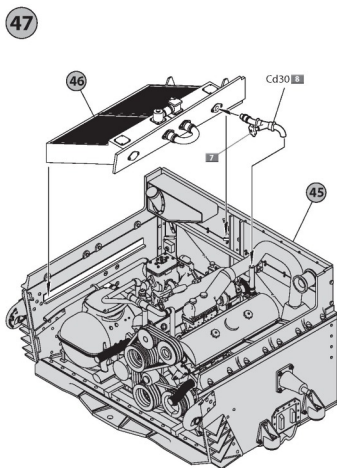
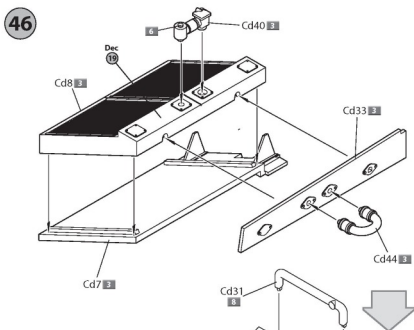
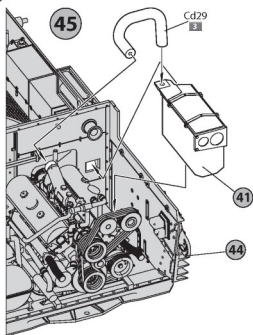



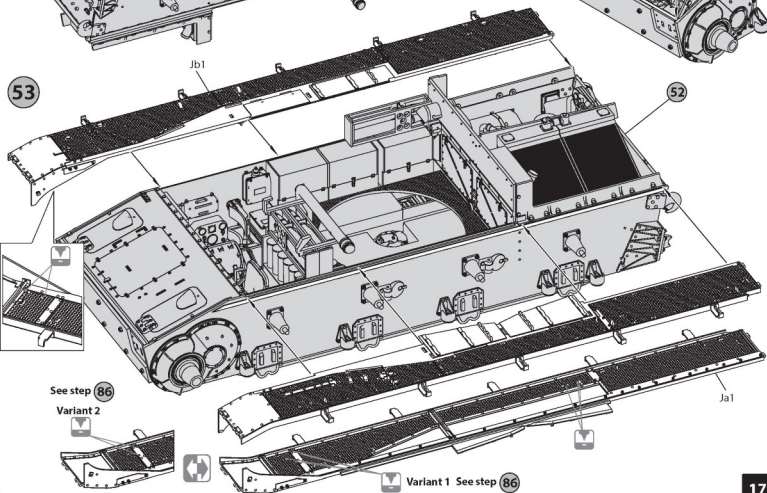
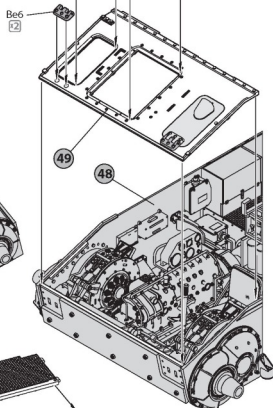
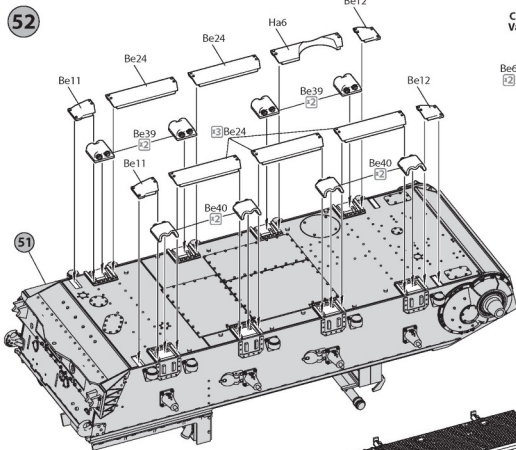
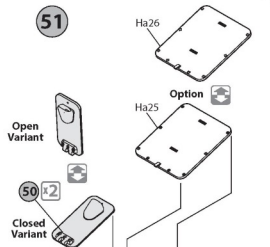
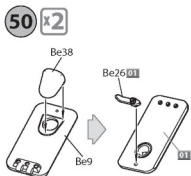
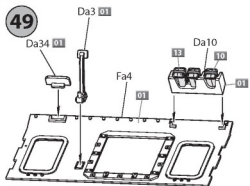

54

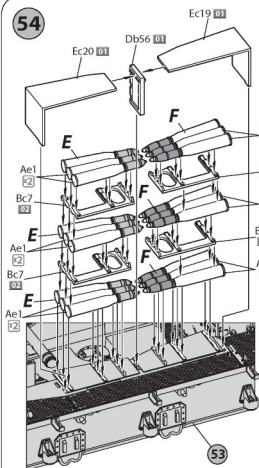

55

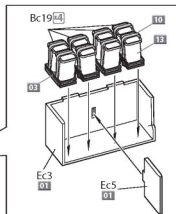
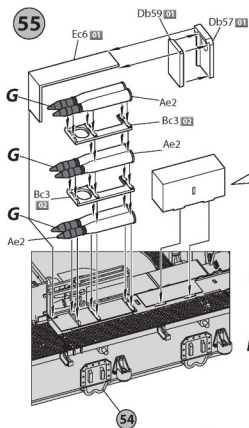

E+3



F+3

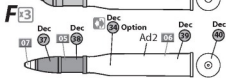

G+3

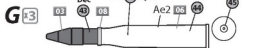

56

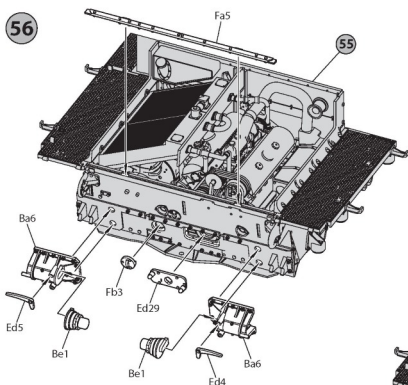

57

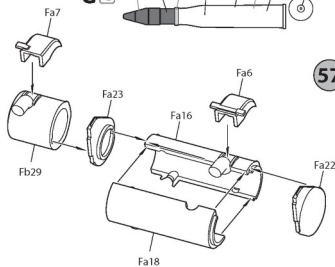

58

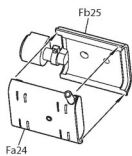

59

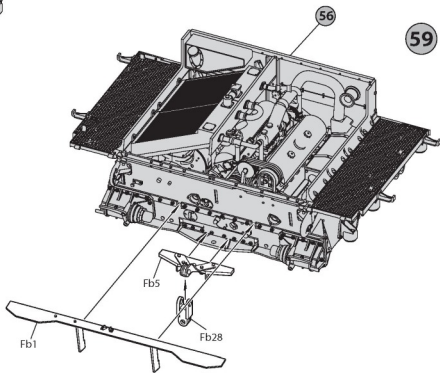

60

A

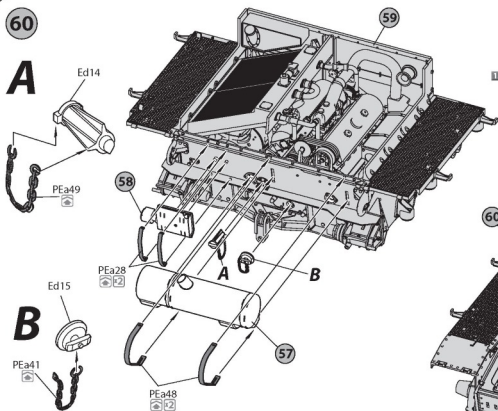

61

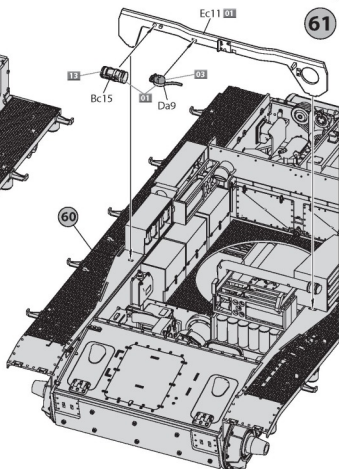

62

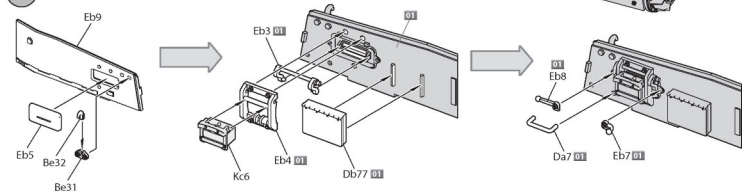

63

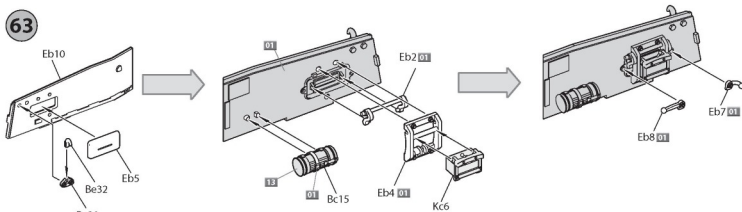

64

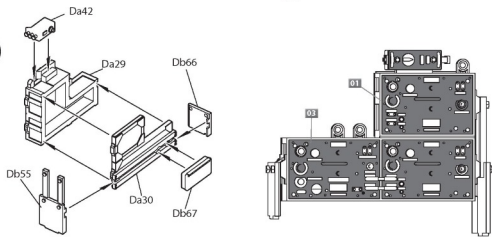

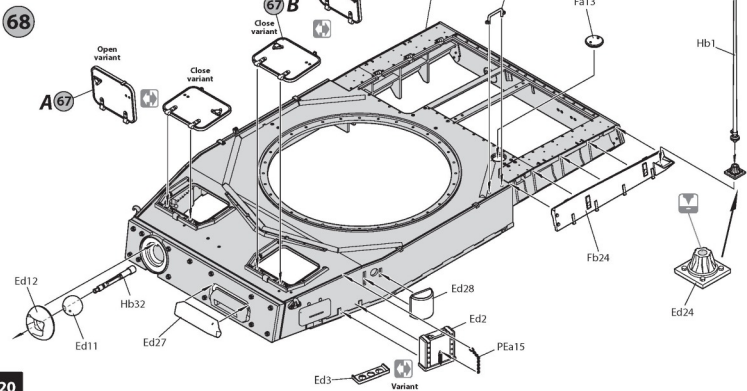
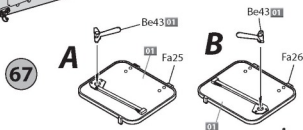
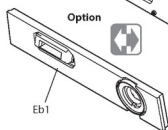
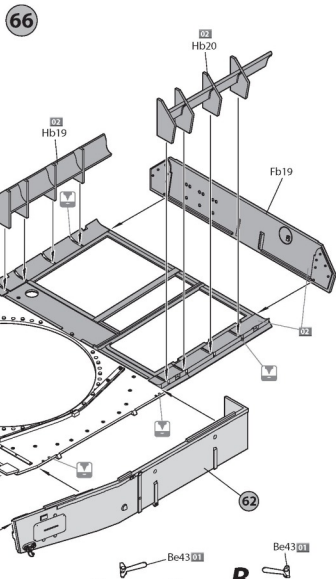
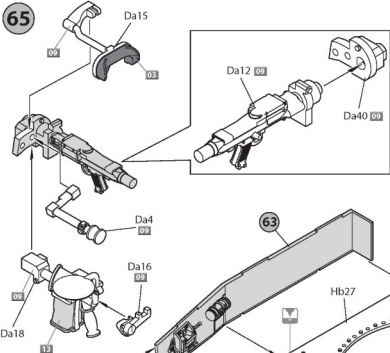

69

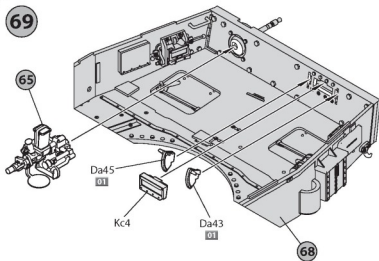

70

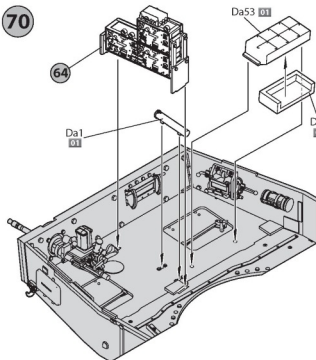

71

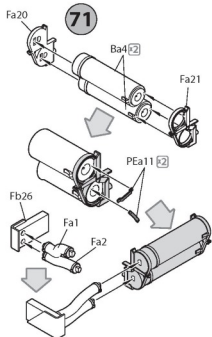

73

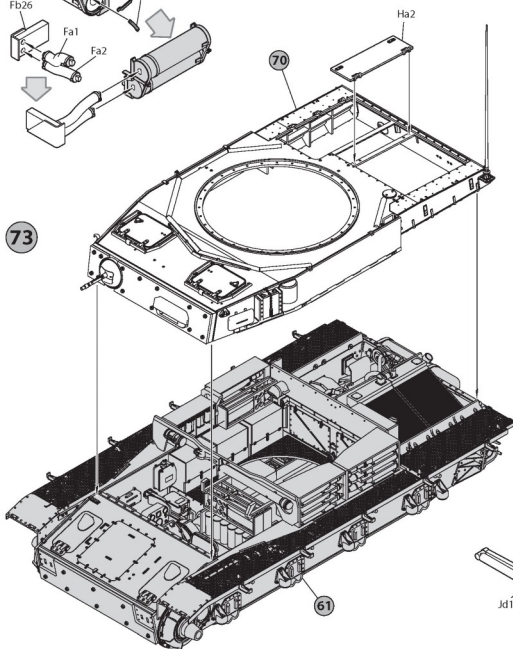

72 x2

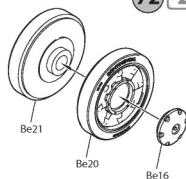

74

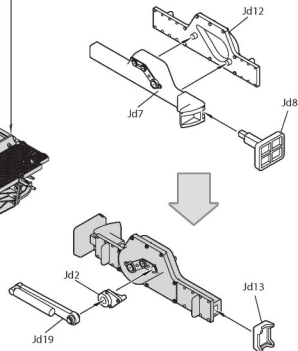

75

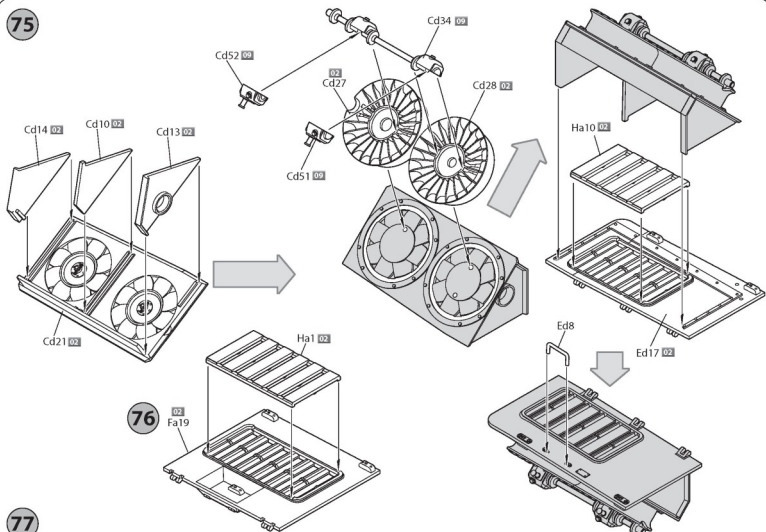

77

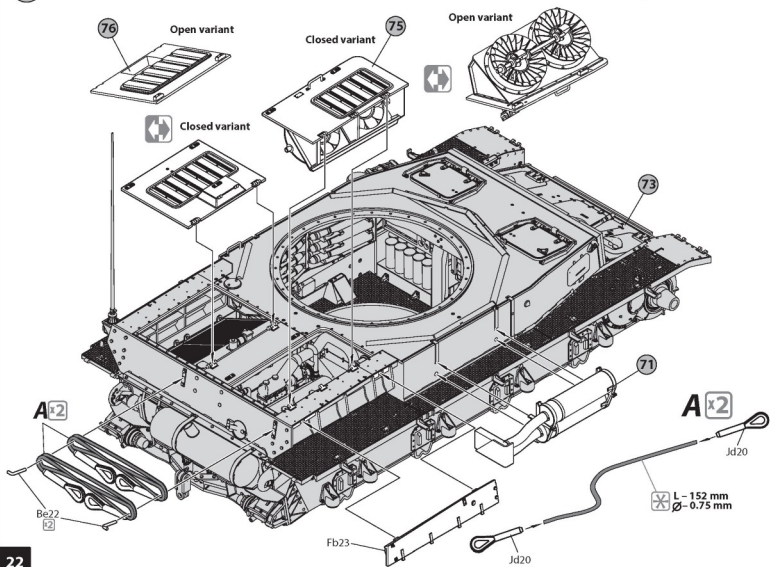

78

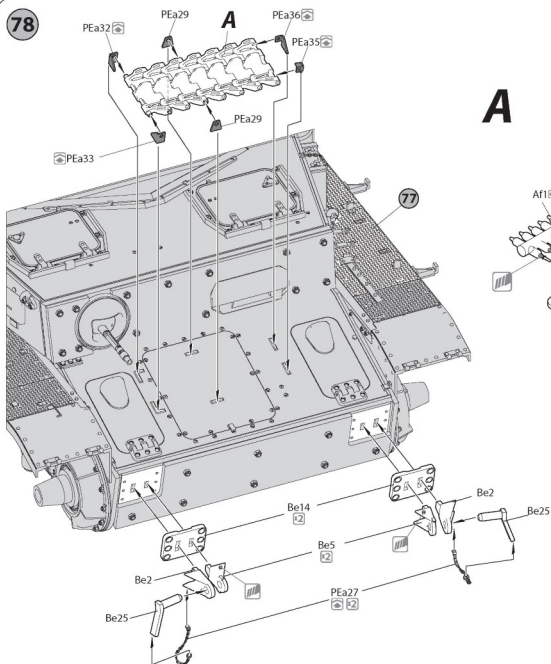

A

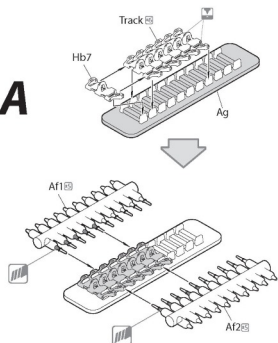

79

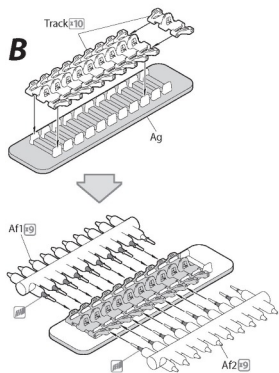

B

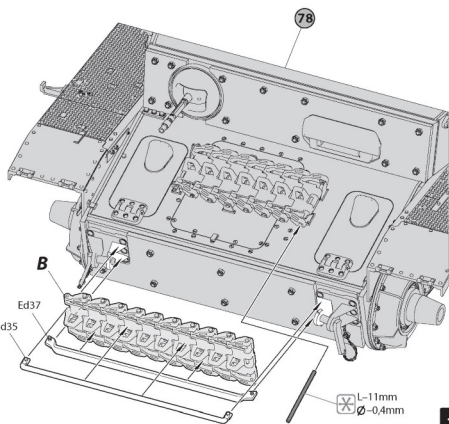

78

B

L=11mm  
 Ø=0.4mm

80

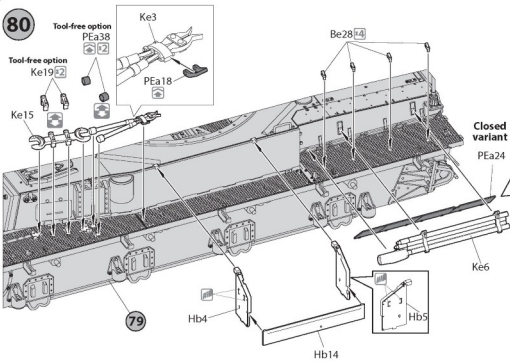

Open variant

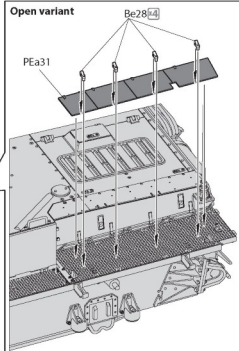

81

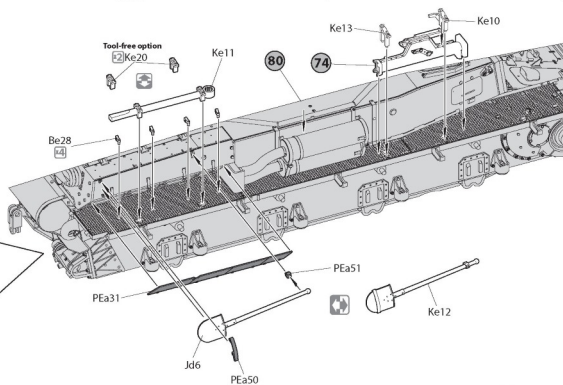
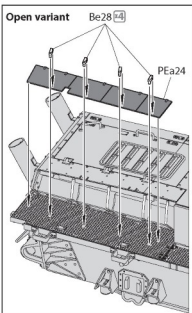

82

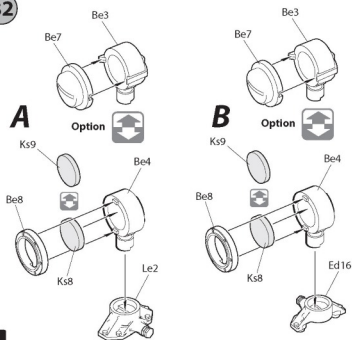

83

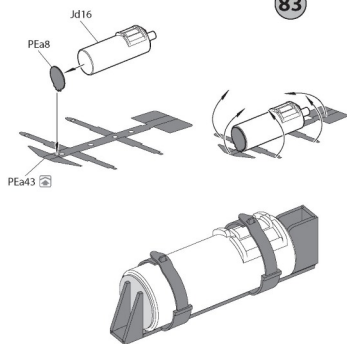



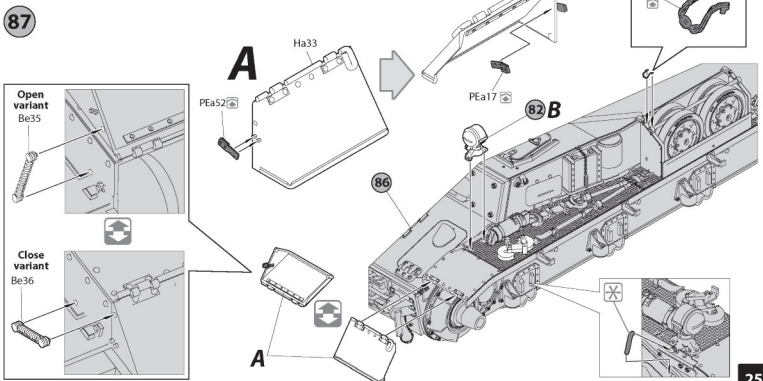
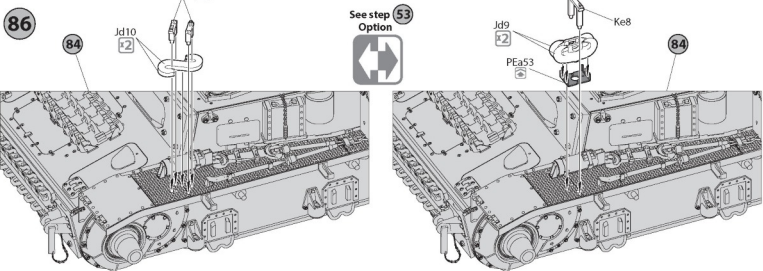
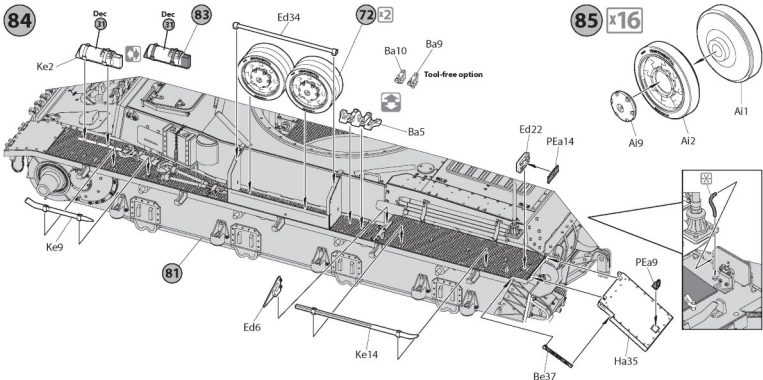

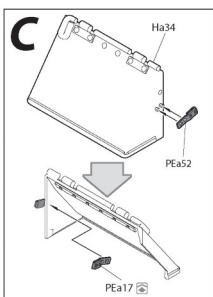
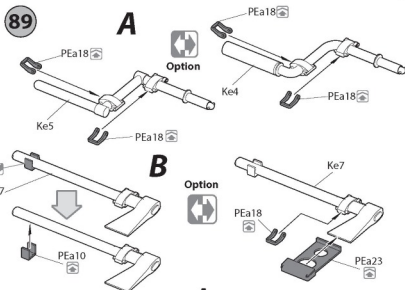
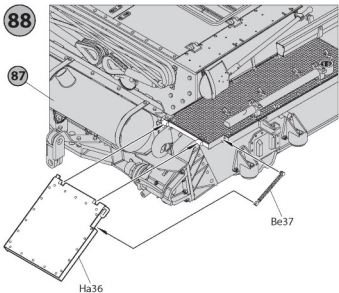

**90**

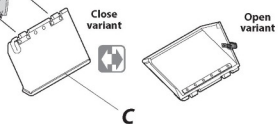
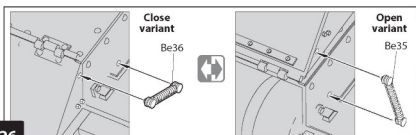
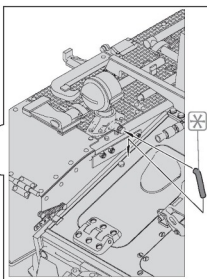
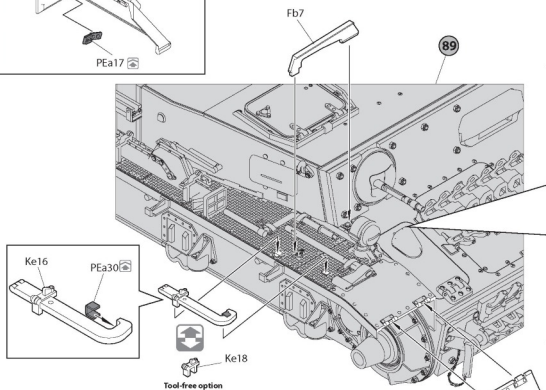
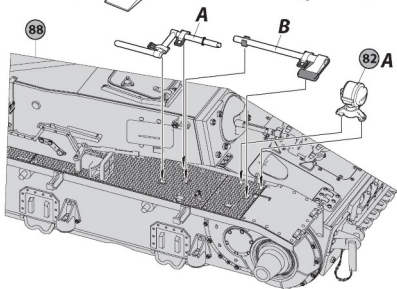

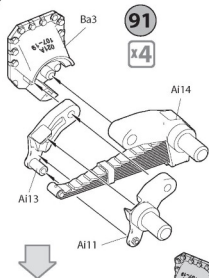

91  
x4

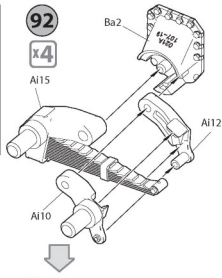

92  
x4

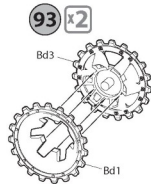

93 x2

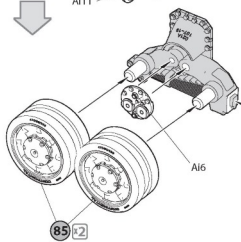

85 x2

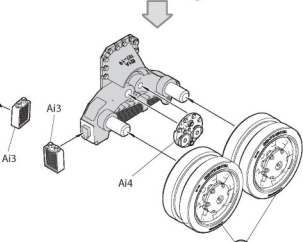

85 x2

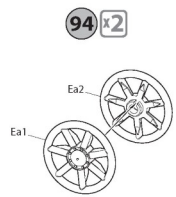

94 x2

96 x2  
Repeat on the reverse side

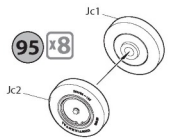

95 x8

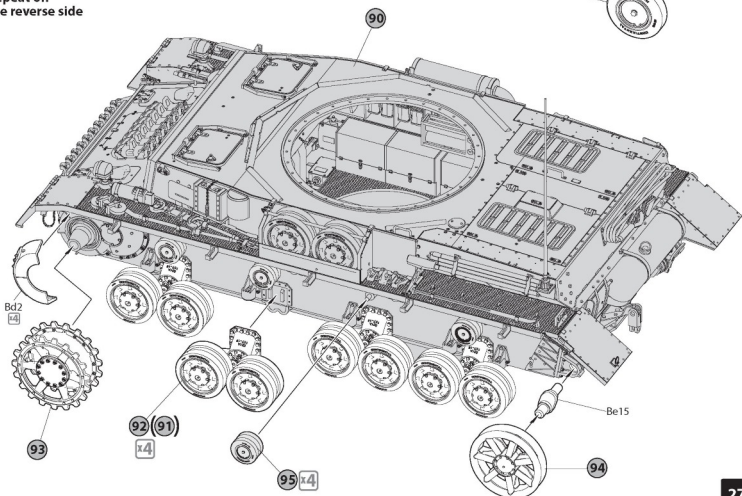

**x2** Each track links contains 101 tracks

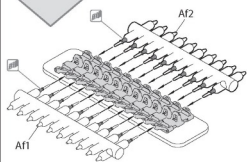
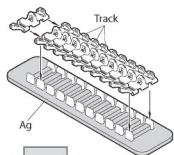

**97**

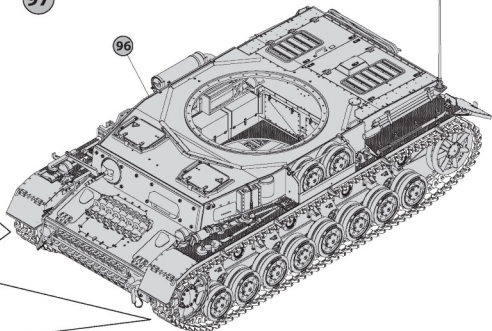

**98**

**97**

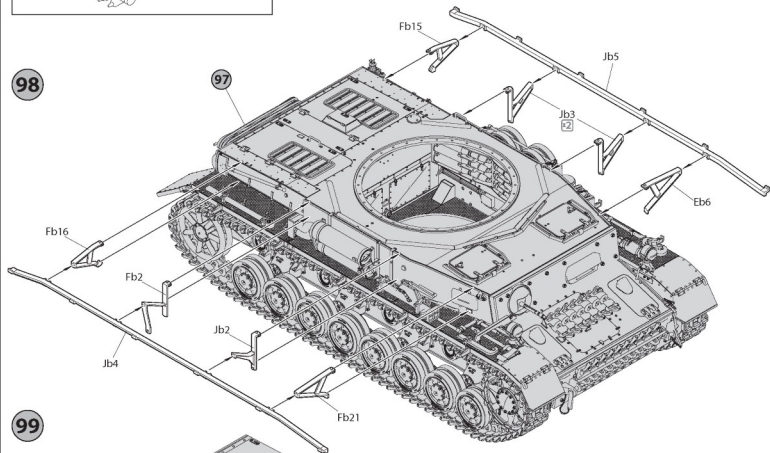

**99**

**98**

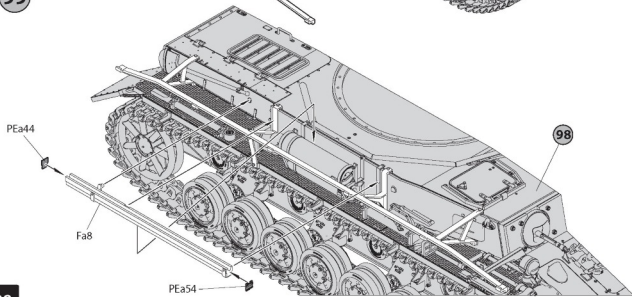

100

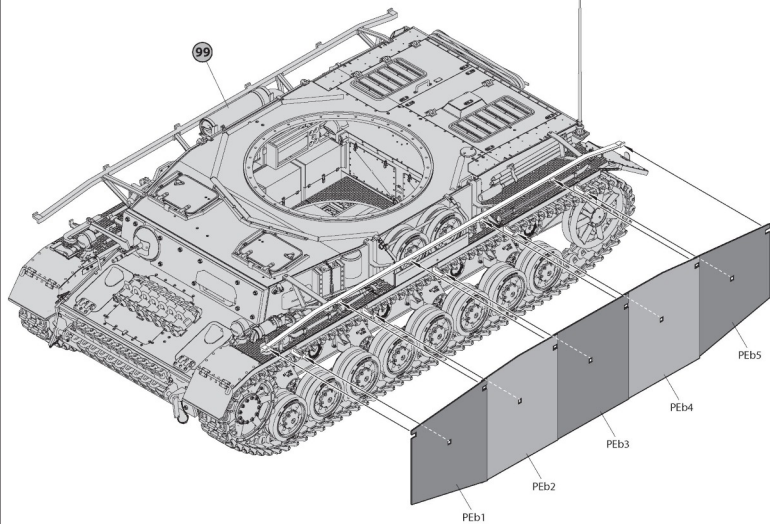

101

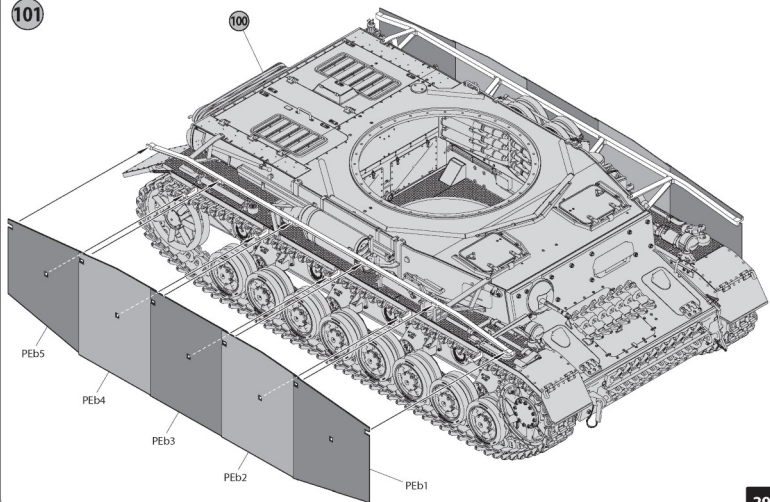

102

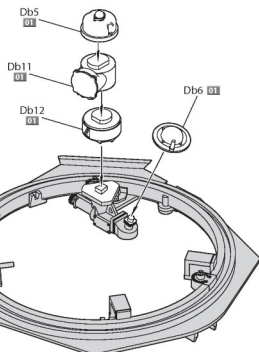
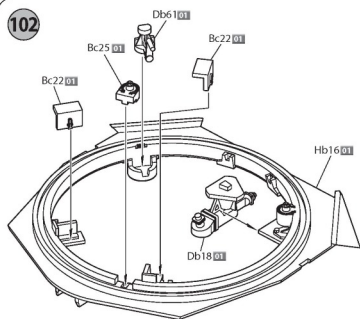

103

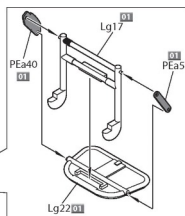
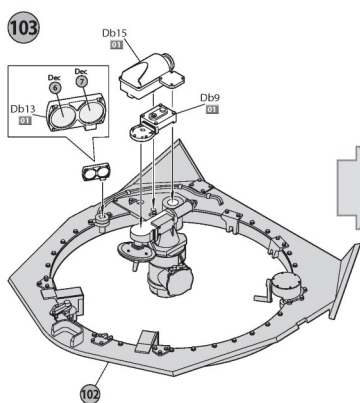

102

104

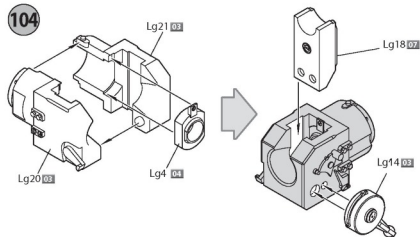

105

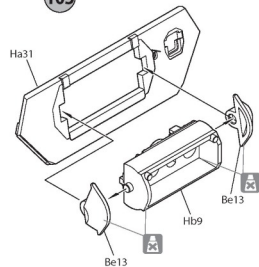

106

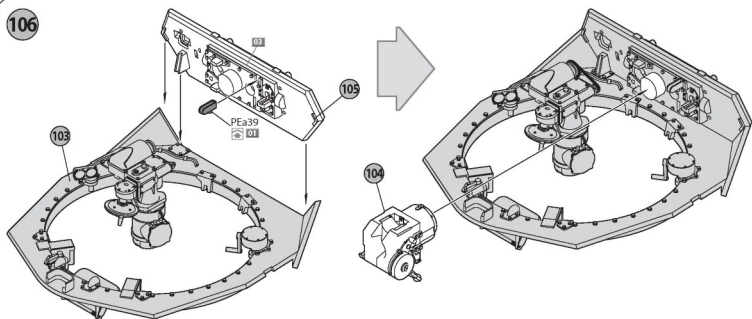

107

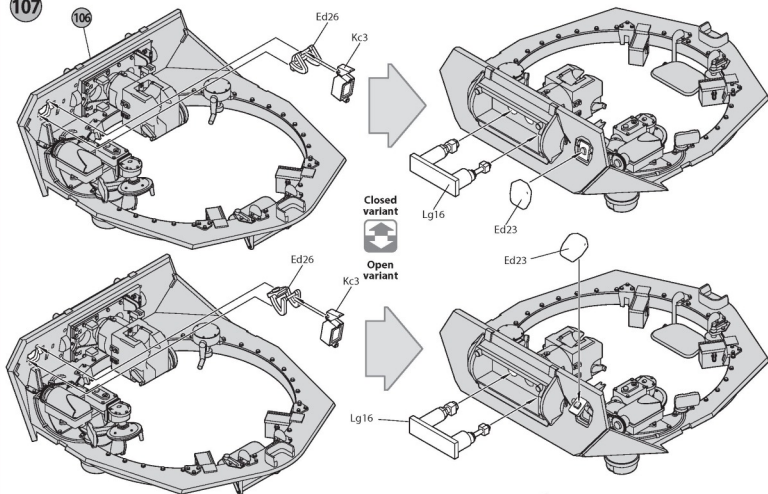

108

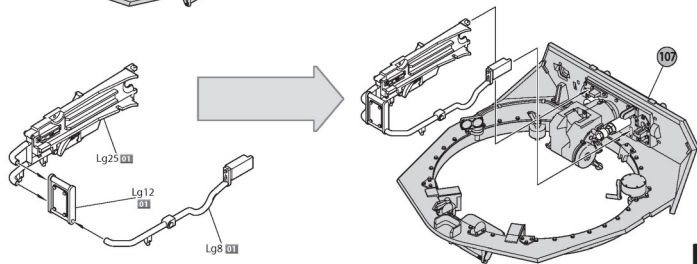

109

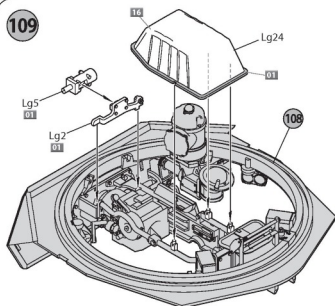

110

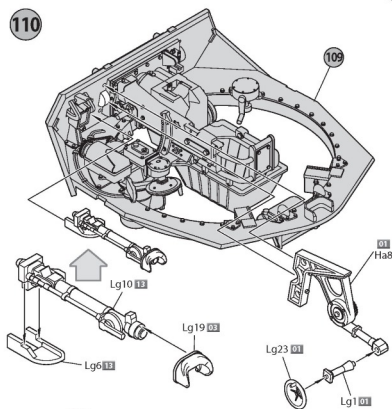

111

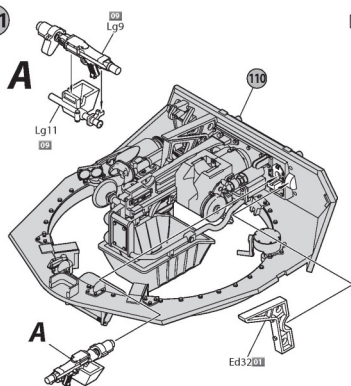

112

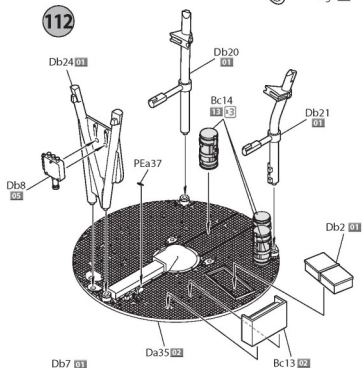

113

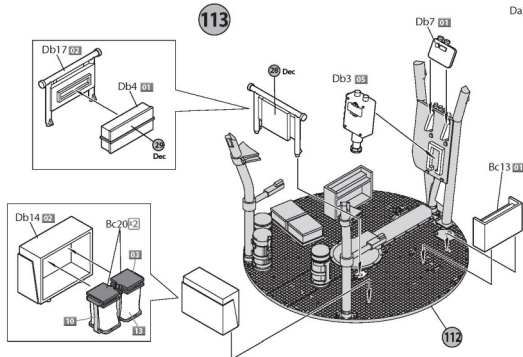

114

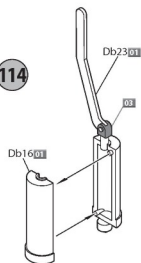



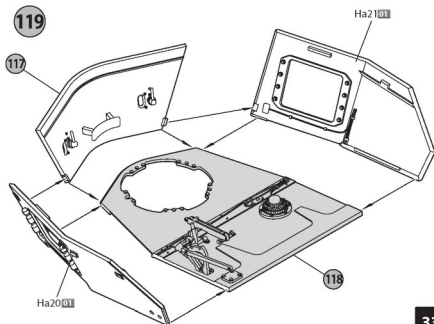
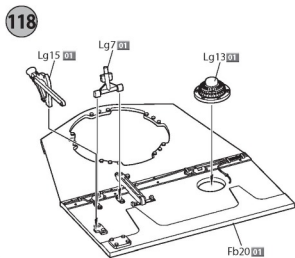
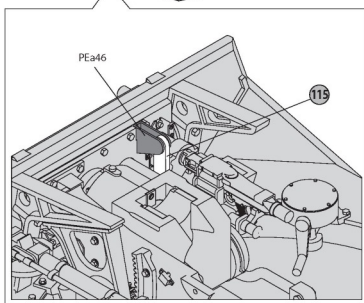
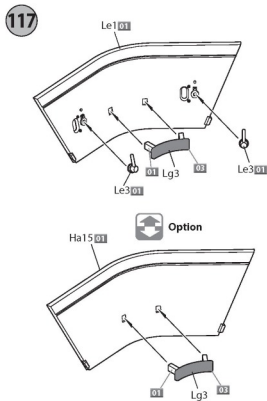
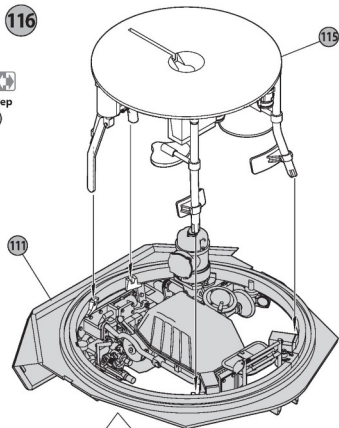
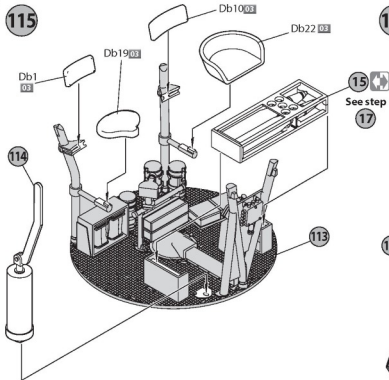

120

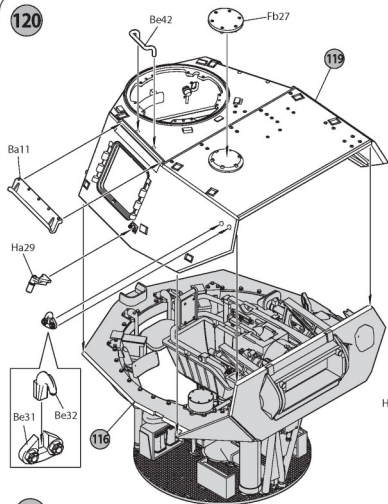

121

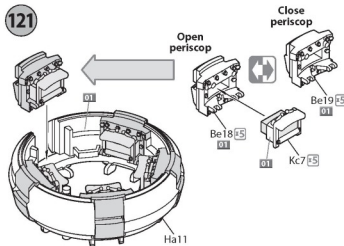

122

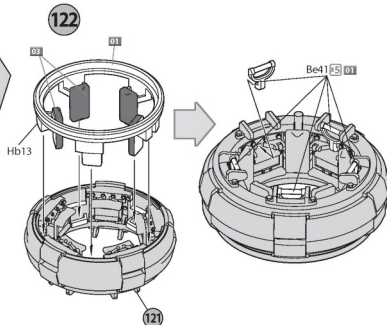

123

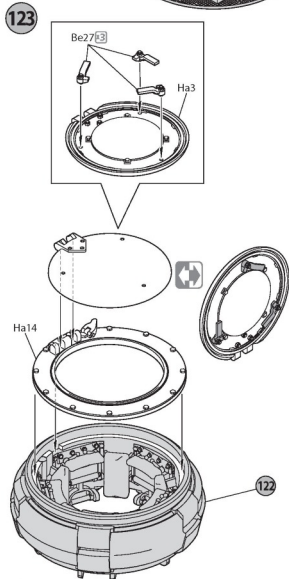

124

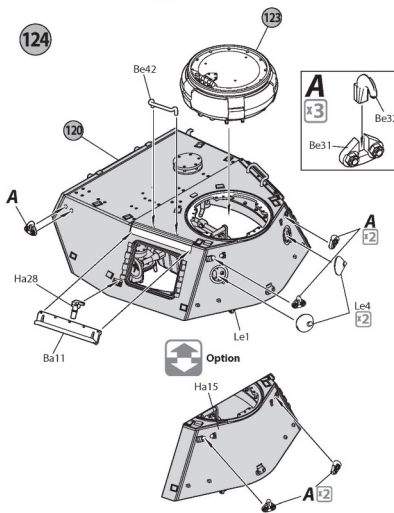

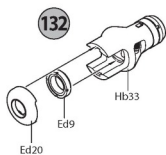
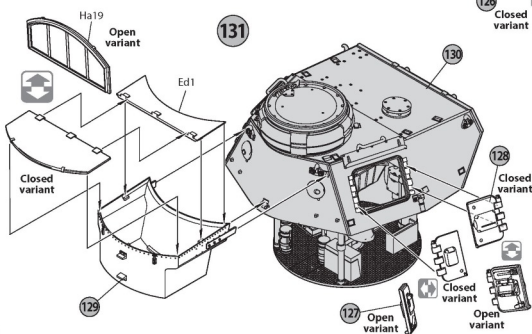
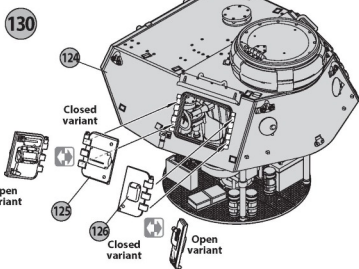
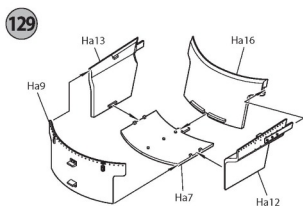
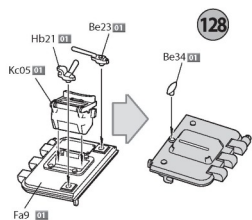
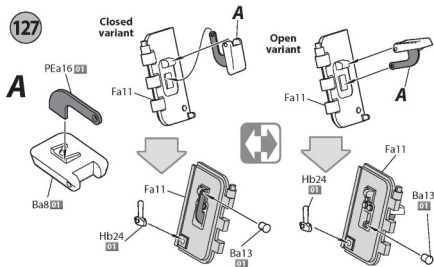
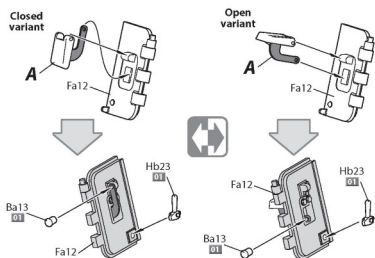
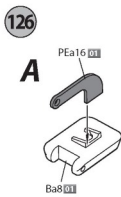
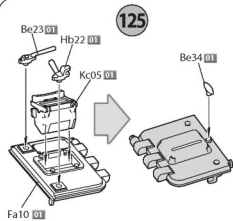

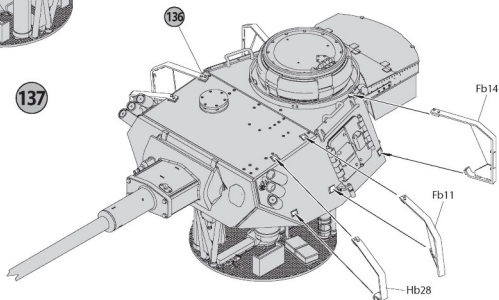
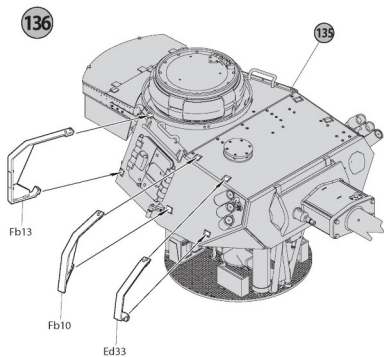
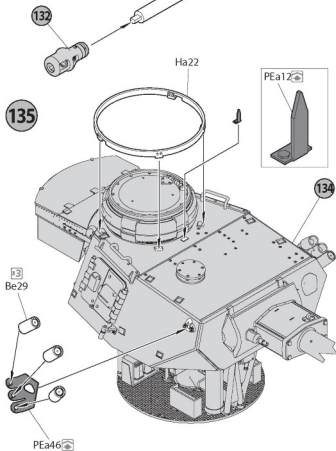
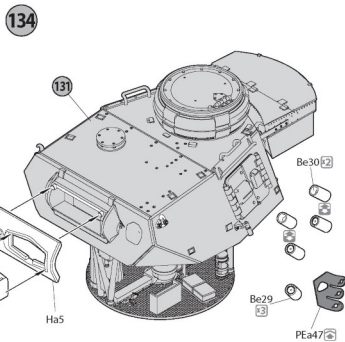
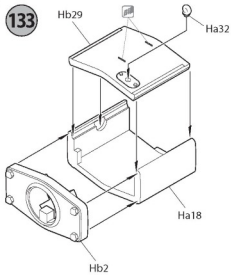

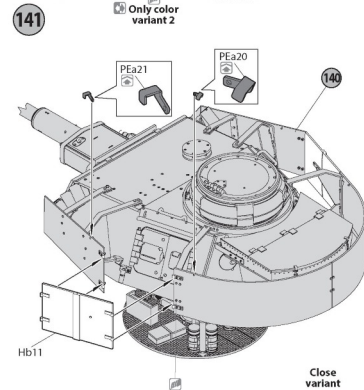
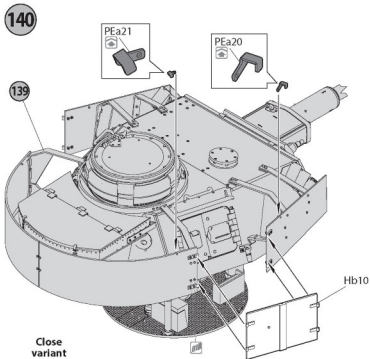
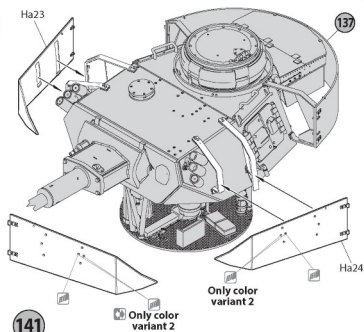
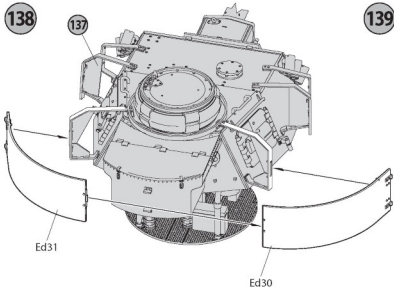

Close variant



Open variant

Close variant



Open variant

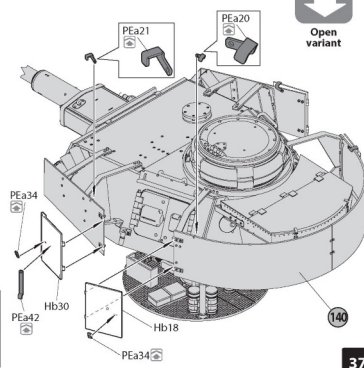
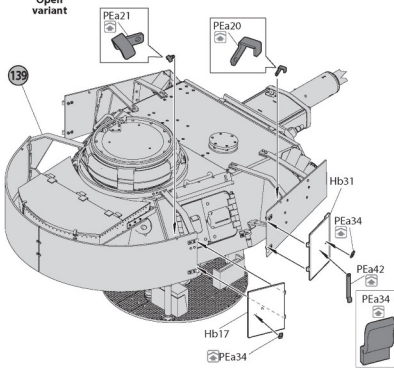

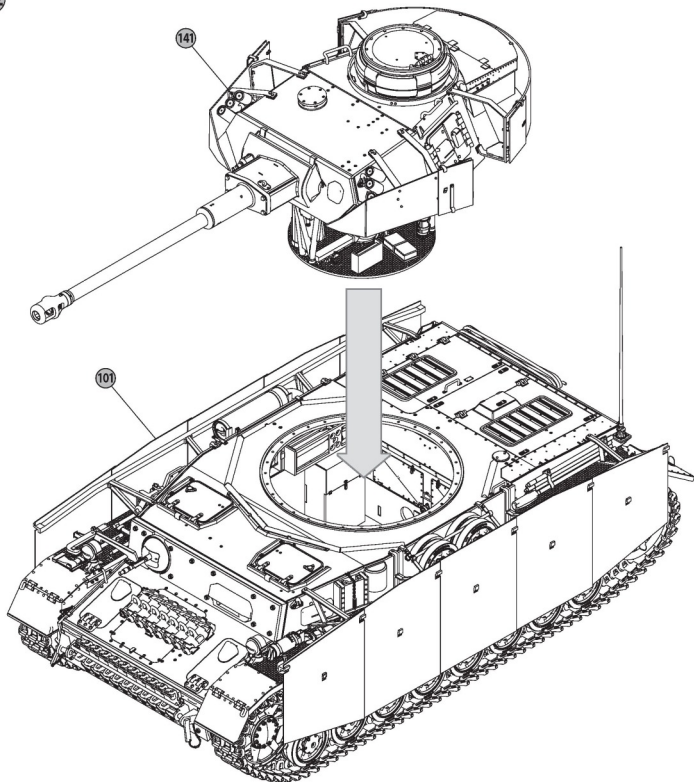

### COLOR CHART

№	Color	Vallejo	Mr. Color	AK RC	Mission Models	AMMO MIG	Tamiya	Color name
01		71.119	C-332	RC-003	MMP-082	A.MIG-0017	XF-02	Cremschweiss
02		71.271	C-41	RC-067	MMP-015	A.MIG-0014	XF-44	German Rotbraun
03		71.057	C-033	RC-001	MMP-047	A.MIG-0046	XF-01	Black
04		71.072	C-028	AK-476	MMM-002	A.MIG-0191	XF-56	Steel
05		71.056	C-040	RC-057	MMP-014	A.MIG-0008	XF-63	Dunkelgrau
06		71.067	C-219	AK-460	MMM-009	A.MIG-0197	X-12	Brass
07		71.062	C-090	RC-020	MMM-008	A.MIG-0184	XF-16	Aluminium
08		71.003	C-003	RC-006	MMP-003	A.MIG-0049	XF-07	Red
09		71.073	C-078	RC-015	MMM-001	A.MIG-0045	XF-04	Gun Metal
10		71.041	C-310	RC-035	MMP-033	A.MIG-0076	XF-10	Brown
11		71.069	C-131	AK-709	MMP-001	A.MIG-0041	XF-10	Rust
12		71.089	C-005	RC-036	MMP-065	A.MIG-0086	XF-17	Blue
13		71.007	C-038	RC-023	MMP-025	A.MIG-0081	XF-62	Olive Green
14		71.276	C-060	RC-299	MMP-072	A.MIG-0075	XF-55	Light Grey
15		71.025	C-039	RC-062	MMP-011	A.MIG-0010	XF-60	Dunkelgelb
16		71.016	C-012	RC-024	MMP-020	A.MIG-0071	XF-49	Khaki
17		71.001	C-062	RC-004	MMP-001	A.MIG-0050	XF-02	White
18		70.976	C-043	RC-030	MMP-076	A.MIG-0037	XF-79	Wood
19		71.251	C-137	RC-022	MMP-040	A.MIG-0033	XF-85	Tire Black
20		71.041	C-147	RC-068	MMP-012	A.MIG-0015	XF-10	Schokobraun

# Pz.Kpfw.IV Ausf. H Vomag

## EARLY PROD. MAY 1943

PAINTING GUIDE **2** Pz.Rgt. 2, 16 Pz.Div. Salerno front. Italy, September 1943.

SCALE  
**1:35**

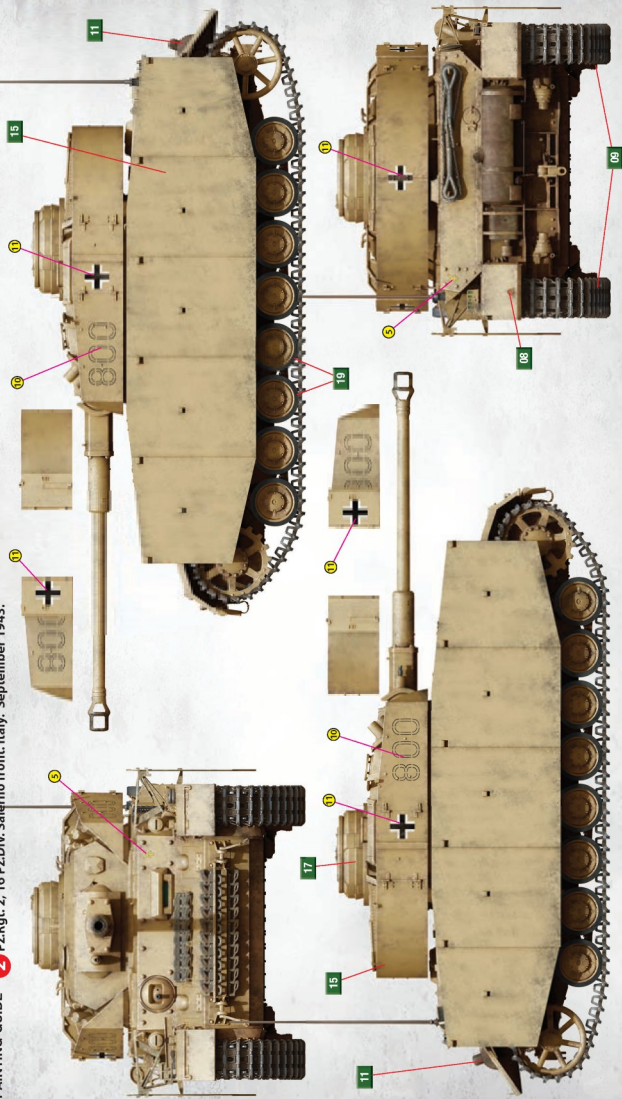

# Pz.Kpfw.IV Ausf. H Vomag EARLY PROD. MAY 1943



PAINTING GUIDE

**3** Undefined Unit, Soviet Union, Winter 1943/1944

SCALE  
**1:35**

