

ADVANCED KIT

AIRPLANES SERIES

THUNDERBOLT Mk.II ROYAL AIR FORCE

48012



GENERAL INSTRUCTION

**SCALE
1:48**

- HIGHLY DETAILED PLASTIC MODEL KIT
- PHOTO-ETCHED PARTS INCLUDED
- CLEAR PLASTIC PARTS INCLUDED
- HATCHES CAN BE ASSEMBLED IN OPEN OR CLOSED POSITION
- 3 TYPES OF WHEELS INCLUDED
- ENGINE & COMBAT COMPARTMENT ACCURATELY REPRESENTED IN THE MODEL
- DECAL SHEET FOR 3 VARIANTS

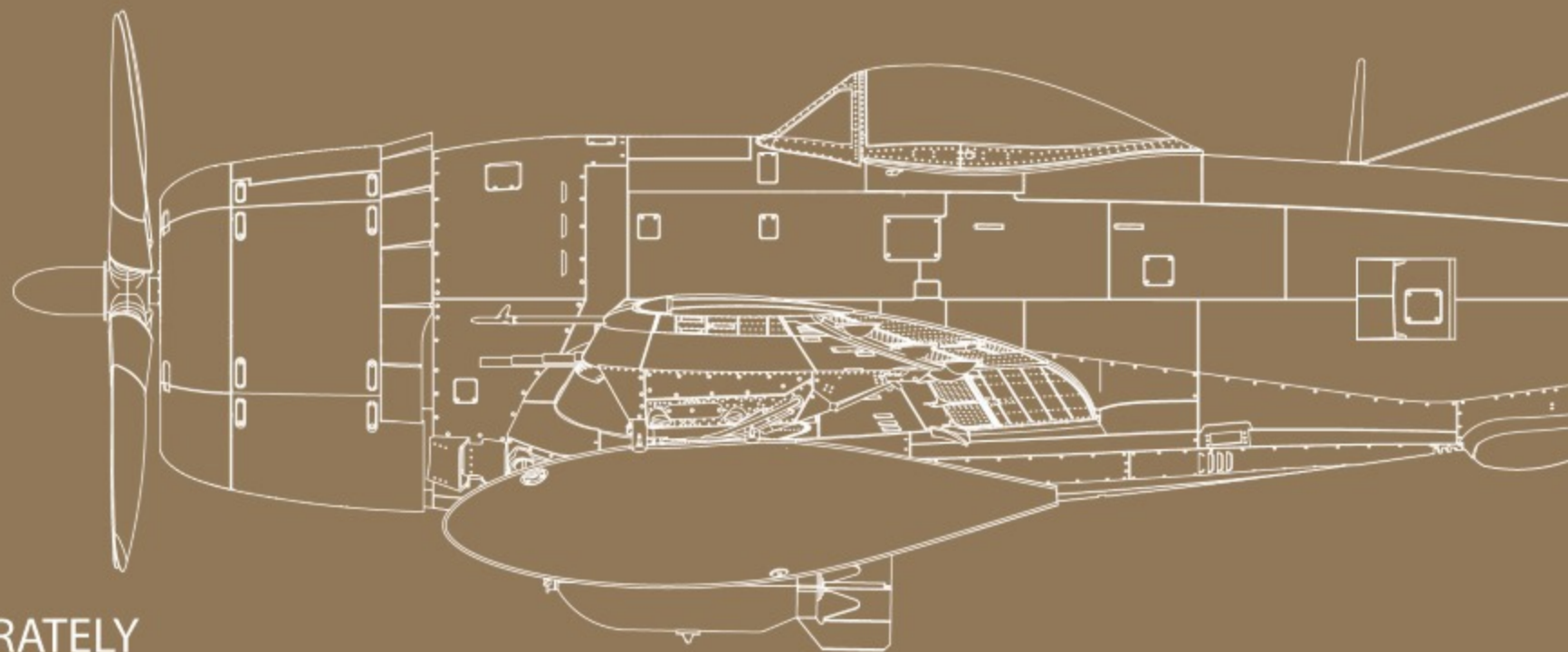

1 30th Squadron RAF South East Asia Command India.
Jumchar, Autumn 1944



2 No. 73 Operational Training Unit (OTU), RAF. Egypt, Spring 1945

ADVANCED KIT

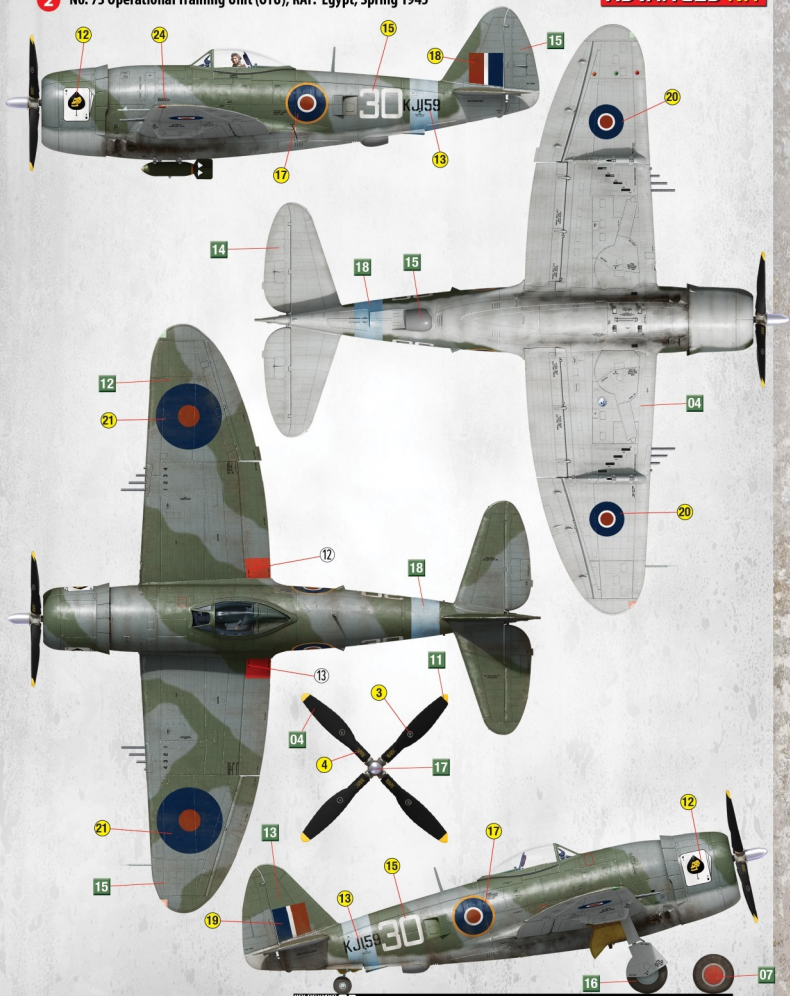

3 79th Squadron RAF South East Asia Command, India, Wangjing, Spring 1945



UWAGA

Przy stosowaniu kleju i farb wszystkie prace należy wykonywać w przewietrzonym miejscu z dala od źródeł ognia.

Oddziel części od wlewków nożem lub innym cienkim narzędziem. Oczyść lampę butylkową i wytnij punkty pilnikiem igłowym i papier ścierny. Złóż modele zgodnie z schemat montażu.

Dla ułatwienia montażu każda część jest oznaczona numerem. Po złożeniu zestawu mogą pozostać niewykorzystane części.

УВАГА

При використанні клею та фарб всі роботи проводити подаль від джерел вогню у провітрюваній, що добре провітрюється.

Деталі відокремлювати від литьових ножем або іншим ріжучим інструментом. Зачистити об'єкти і місця з'язу за допомогою наждачки та наждачного паперу. Вигладжувати моделі використовувати глибоку іголку та наждачний папір. Збирати моделі відповідно до схеми. Для зручності побудови кожна деталь позначена номером.

Після складання можуть залишитися невикористані деталі.

CAUTION

When you use glue or paint, do not use near open flame, and use in well-ventilated room. When you take parts off from the runner frame, use modeling scissors or cutter.

See the bottom of this column for the meaning of symbols. Extra details can remain after assembling of the kit.

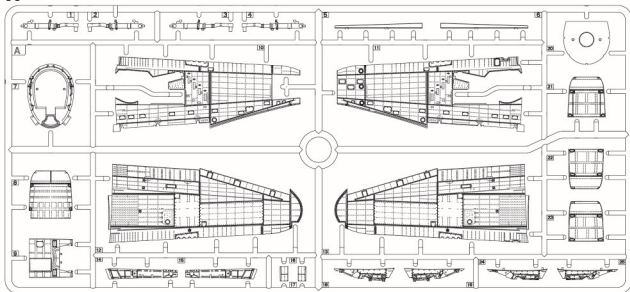
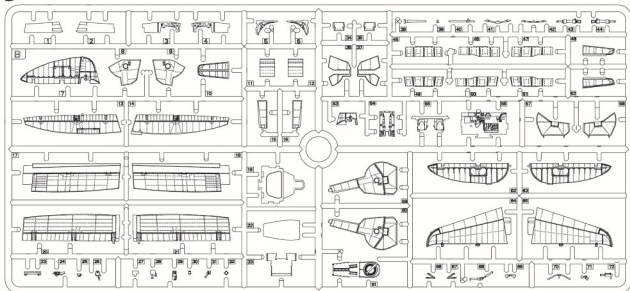
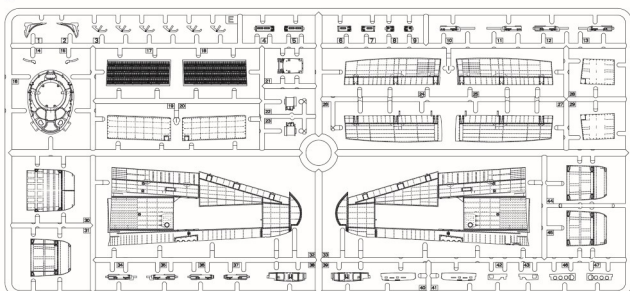
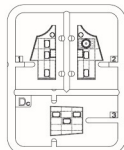
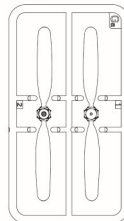
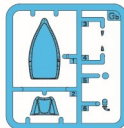
PARTS**A****B****E****Dc****Ga****Gb****Clear Parts****PE M-220**



POWTOZC DWA RAZY
MAKE TWICE
2 TEILE FERTIGEN
EFFECTUERS 2 PIECES
FARE DUE PEZZI
TÉ 2 PÉK
GOR 2 ST
KIBYKCTB PA3IB



NE UDVAJAJ KLEJUI
DO NOT CELENT
NIGHT KLEBEN
NE PAS COLLER
NON INCOLLARE
EIUMAA
LIMMAJ
HE KREITH



OPĆIE
OPTIONAL
NACH BELIEBEN
FACIL TATIF
FACIL TATTIVO
VALJUNNAKARANEN
VALBAR
BAPIAHYTH



ZYKBIK OZIRE
OPEN HOLE
OFFENEN
FAIRE UN TROU
FORO APERTO
AVLA HEIKA
OPPANA HALET
SPOSHYTH OTBEP



ODĀCĀK
REMOVED
ENTFERNEN
RETRIERER
SEPARARE
POIESTA
AVLĀGASNA
BIDĀSĀTH



ZONĀCĀK
BEND
BITTE BIEGEN
PLIER STIL VOUS PLIAT
PIEGARE
TATA
BOCKA
BIFĀYTH



ZHOG TO SAM
SCRATCH-BUILD
AM MEISTEN ZU MACHEN
FAIRE LE PLUS
RENDITI
TEE ITSE
GOR DIG SJĀLV
SPOSHYTH CANOMY

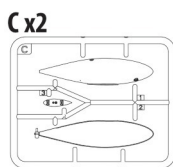
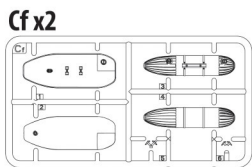
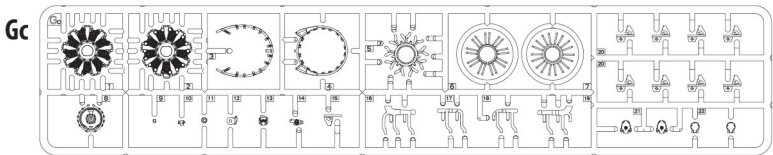
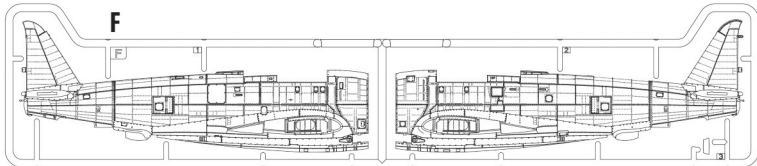
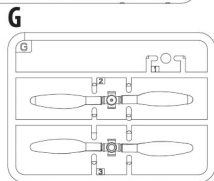
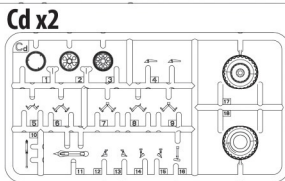
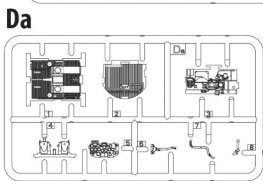
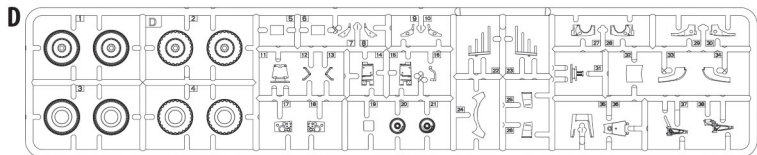

Decal Sheet

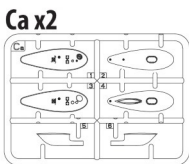
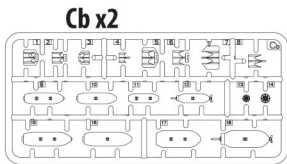

Decal Sheet STENCIL 48-01

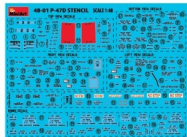

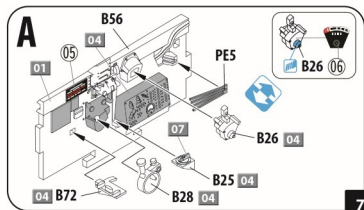
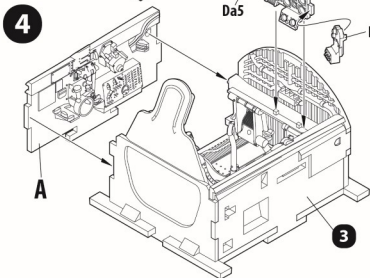
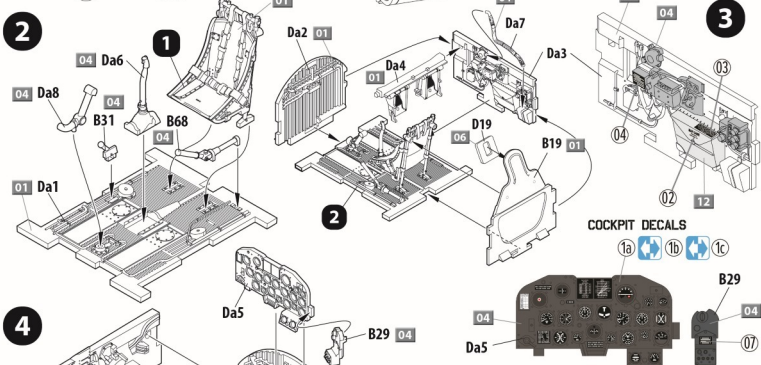
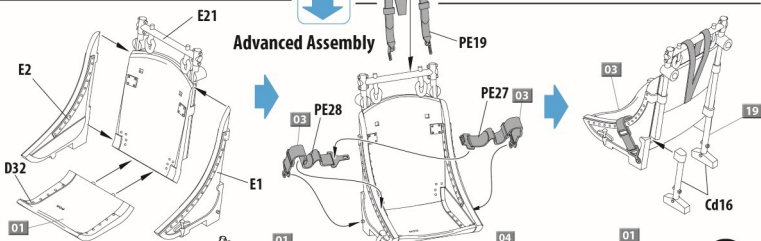
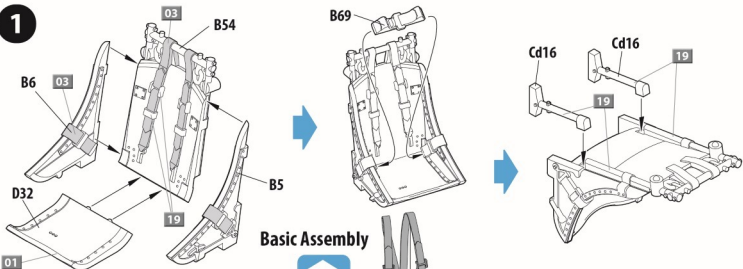

5

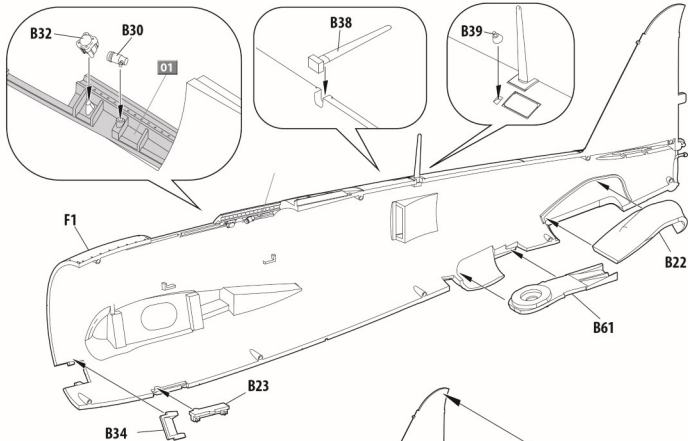

6

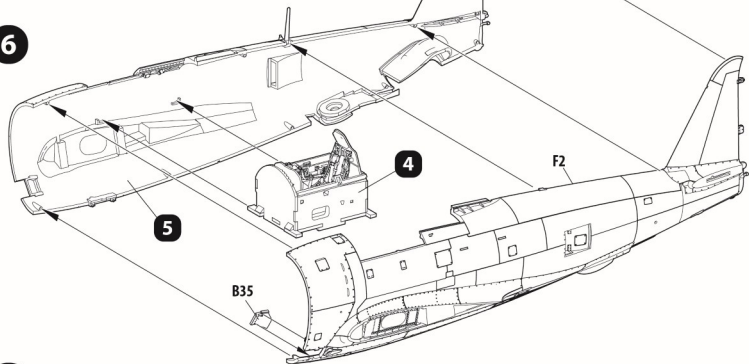

7

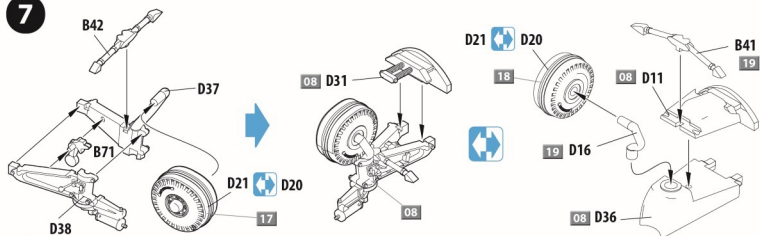

8

8

! for experienced modellers

Advanced Assembly of Engine

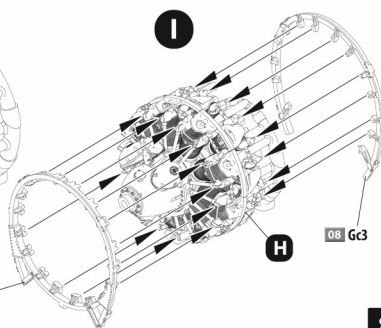
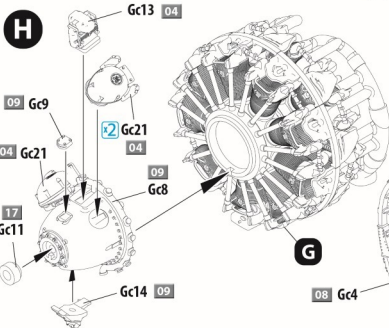
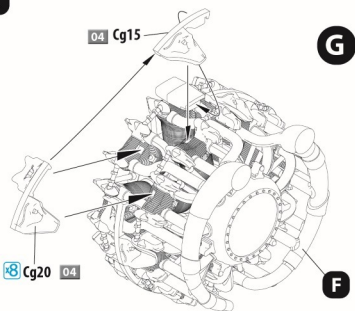
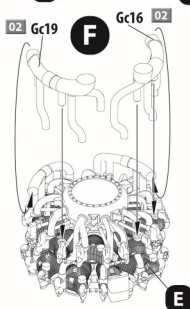
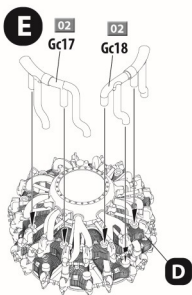
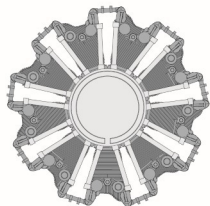
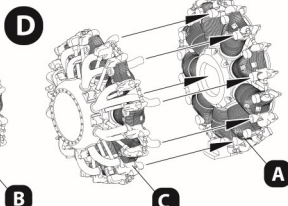
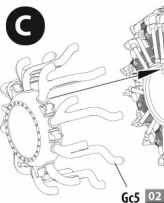
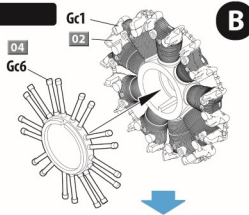
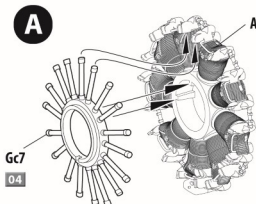
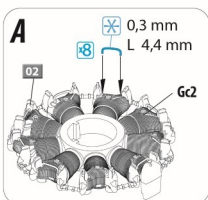

9

9

Basic Assembly of Engine

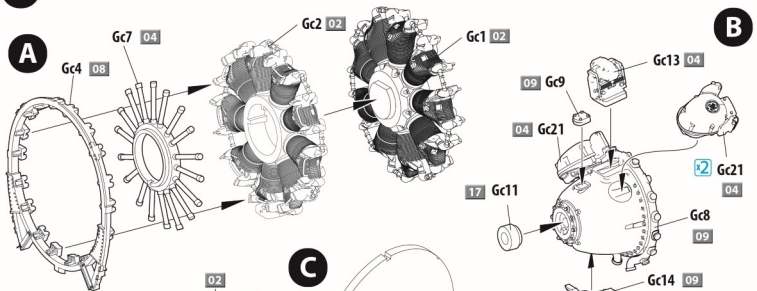

10 Advanced Assembly

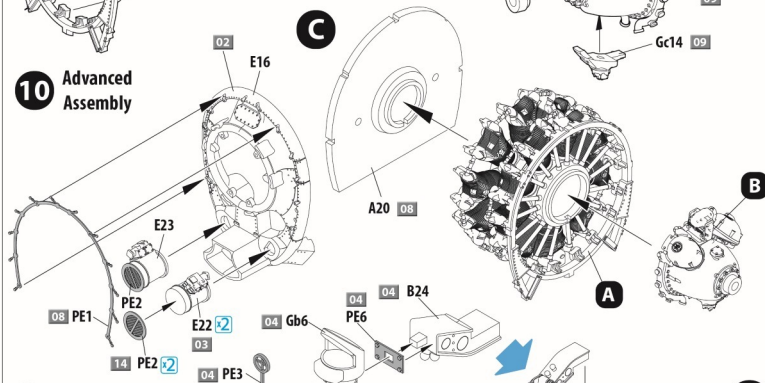

12 Basic Assembly

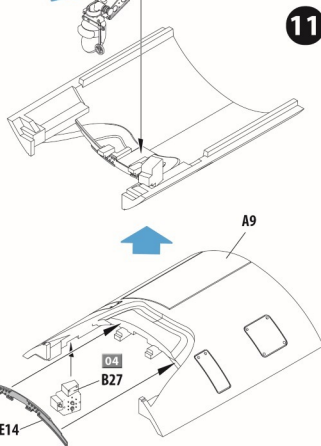
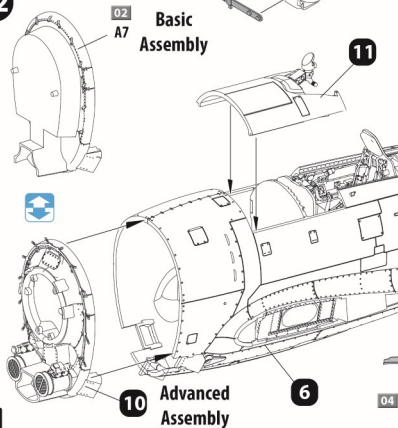

10

13

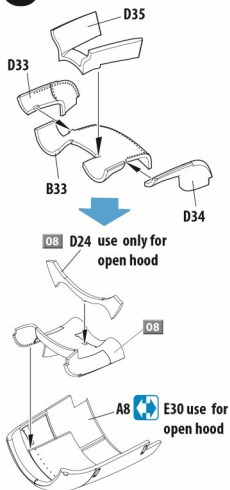

15

Advanced Assembly (Open hood variant)

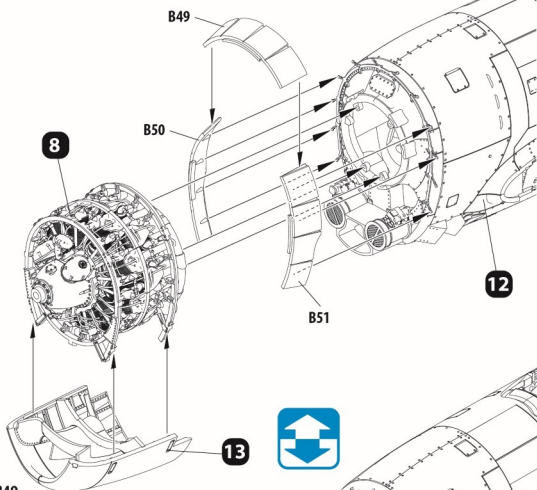

14

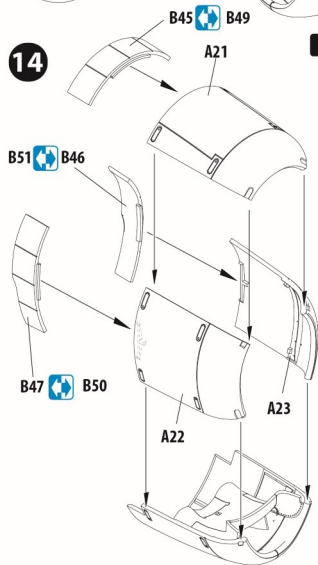

Closed hood variant

Advanced Assembly

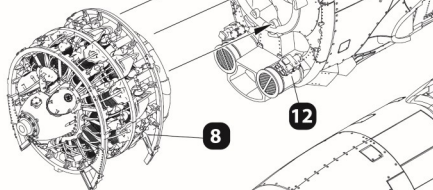

Basic Assembly

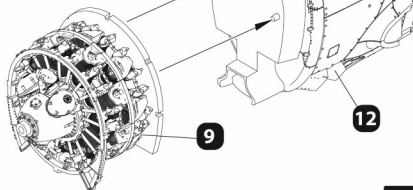

11

16

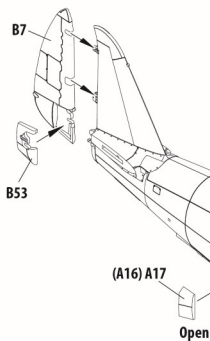

18

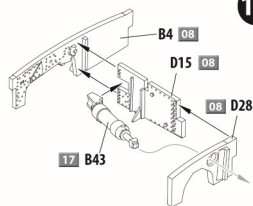

15

14

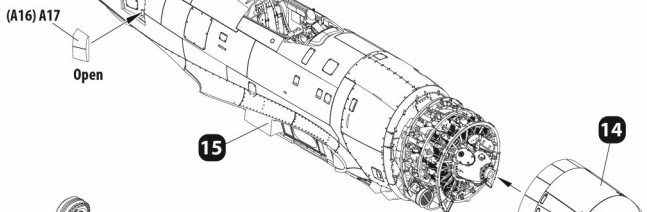

17



Open chassis option



Closed chassis option

F3

16

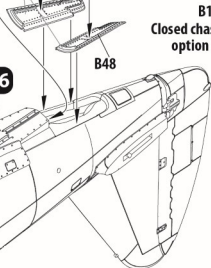

19

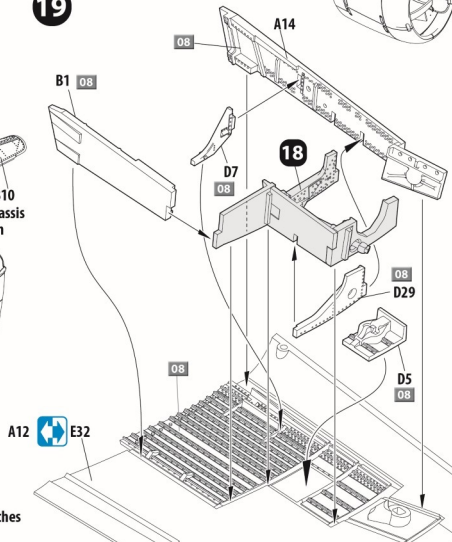

E32 only use with open wind hatches

12

20 Use only for open hatch on the wind

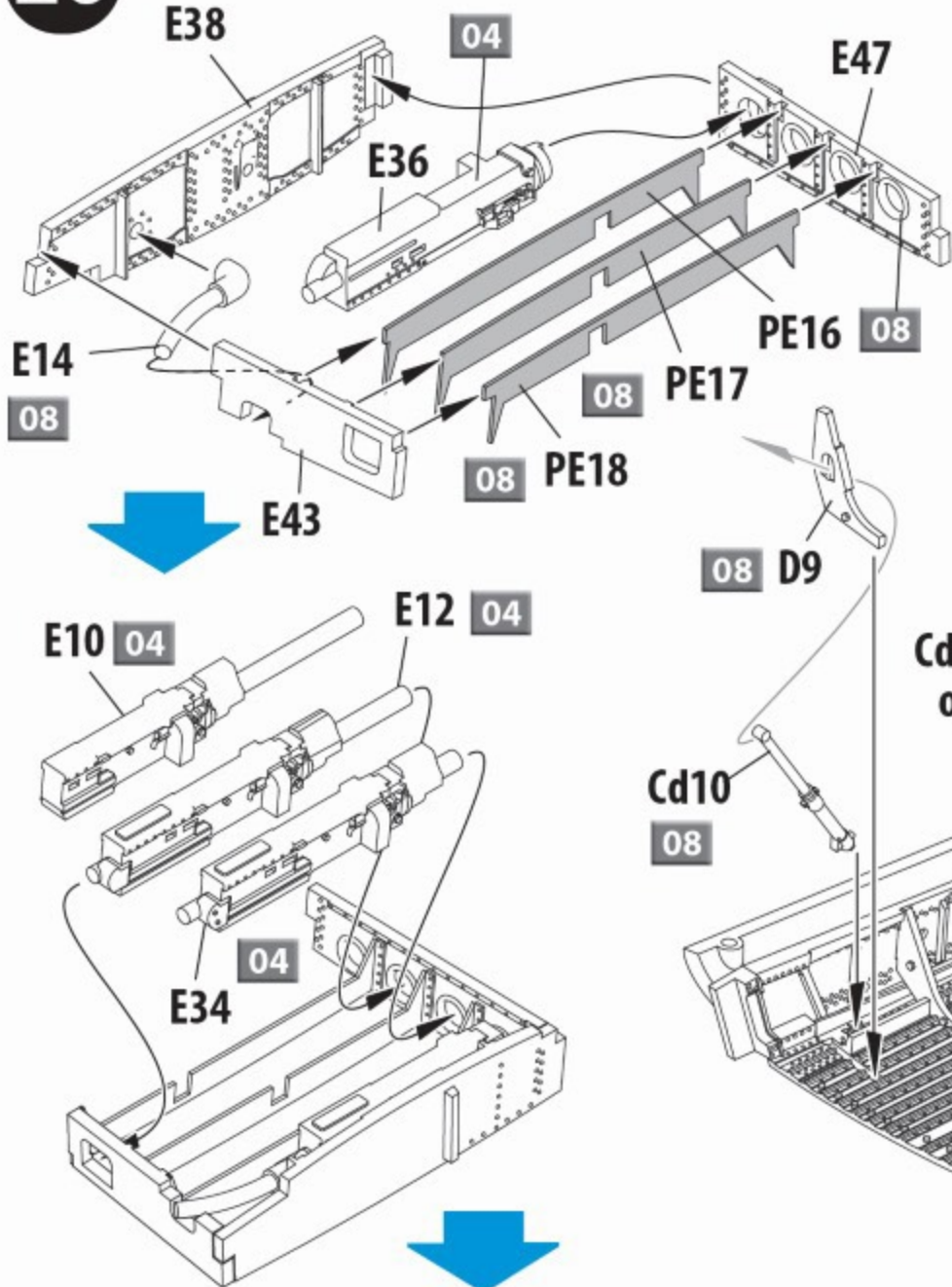

The parts E17 use only for open hatch on the wind

21

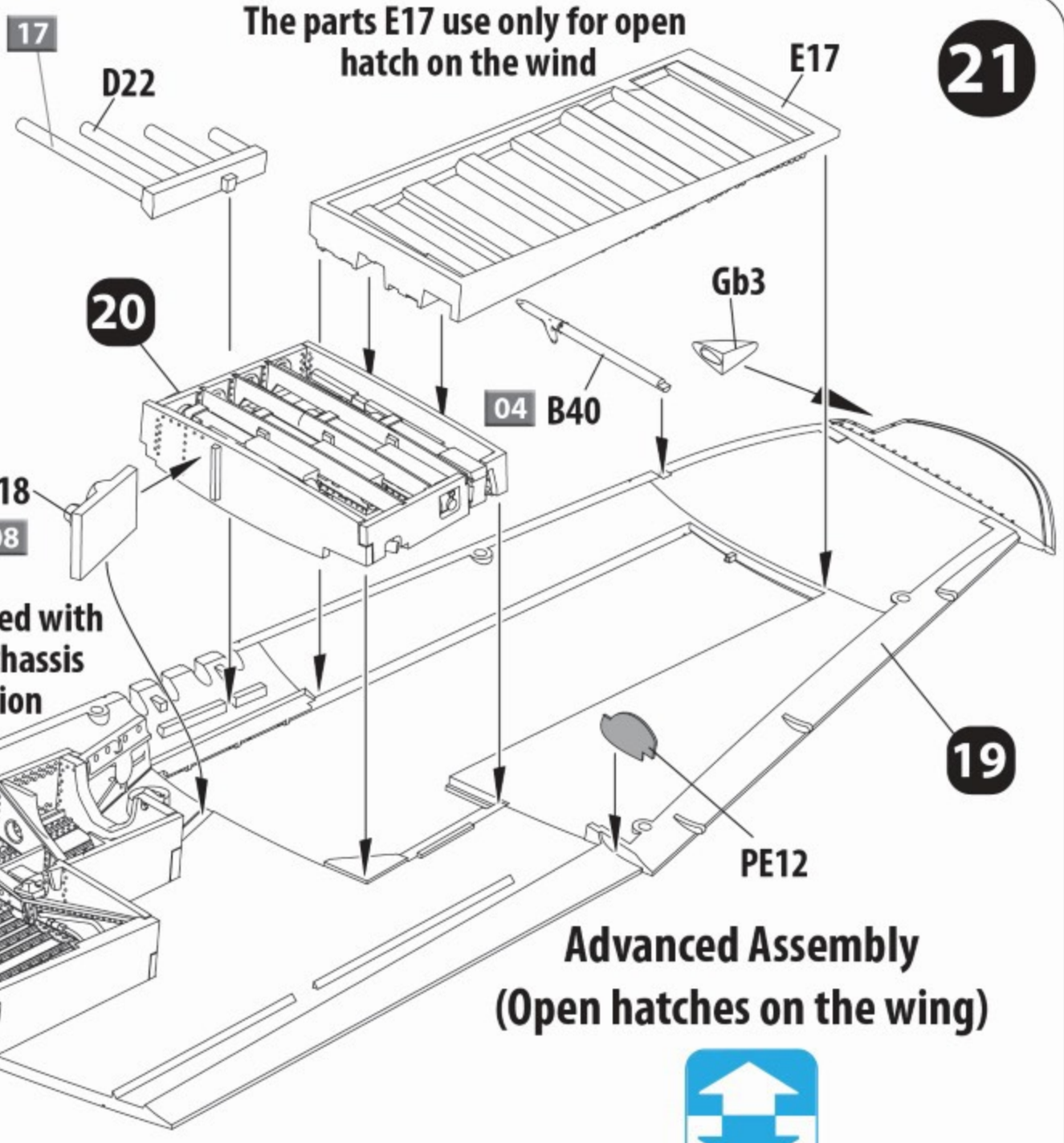

Advanced Assembly
(Open hatches on the wing)



Cd10 used with open chassis option

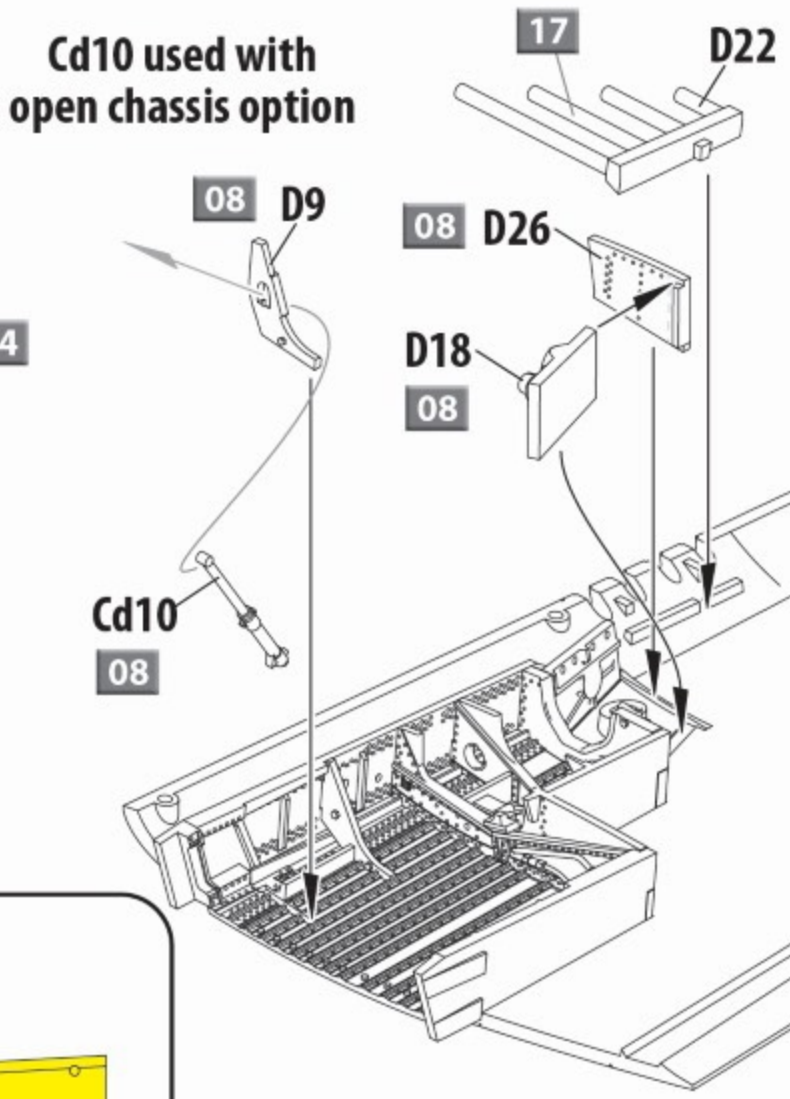

Basic Assembly

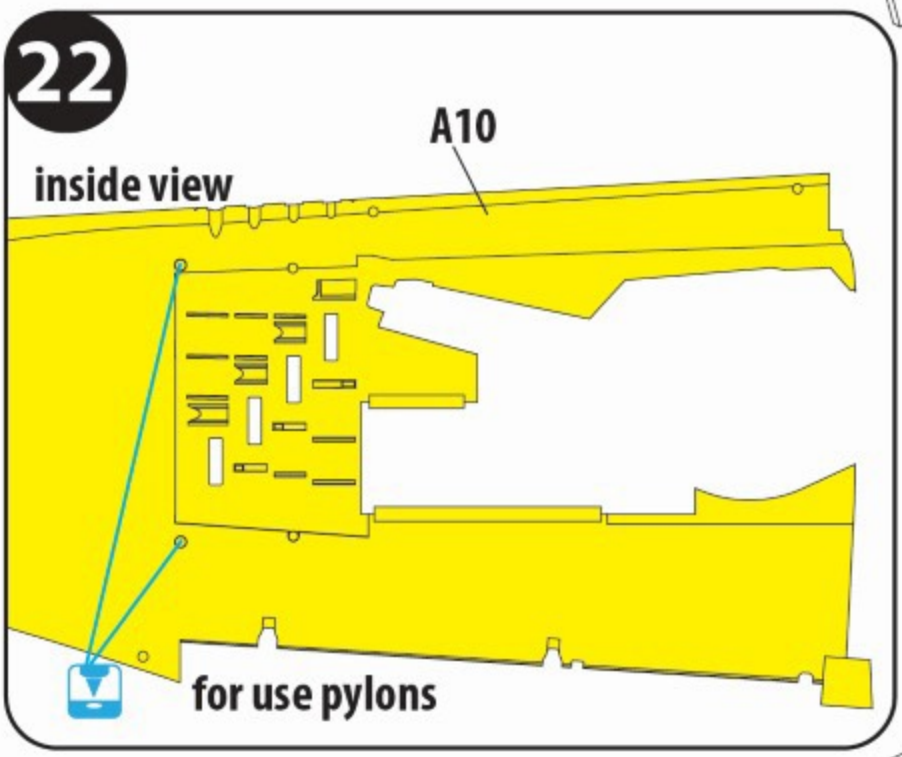
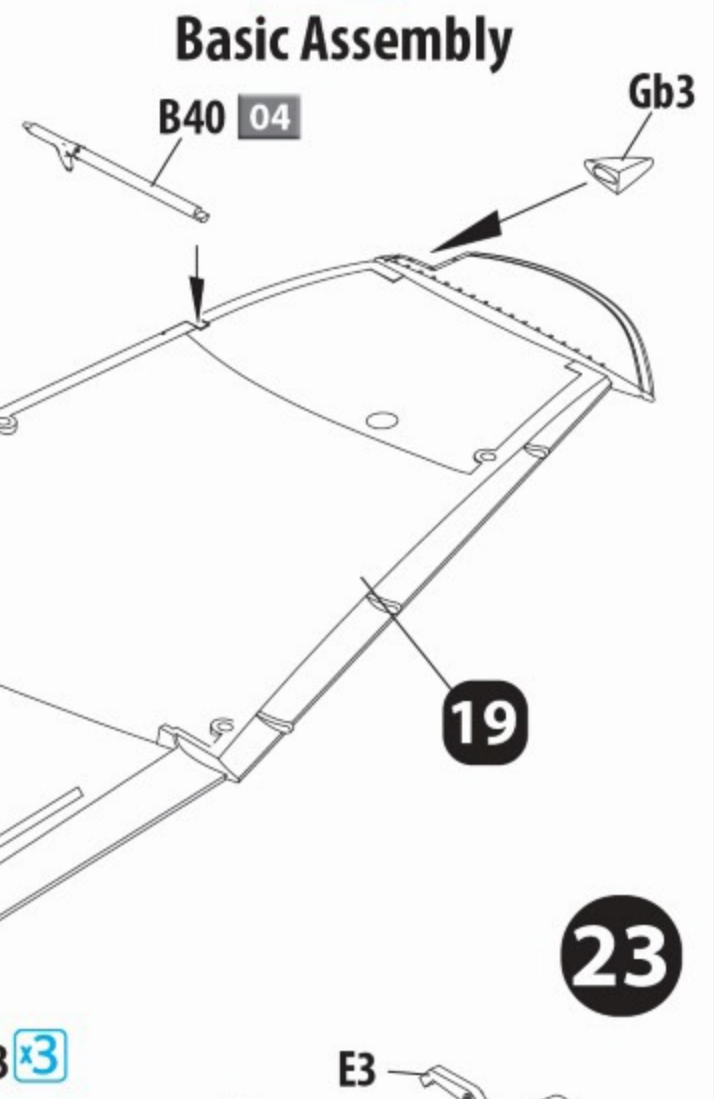

23

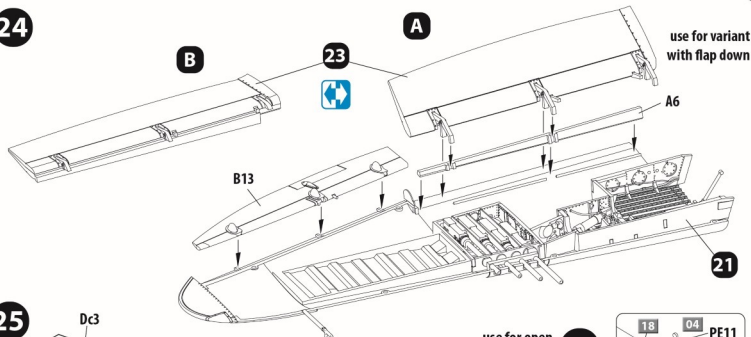
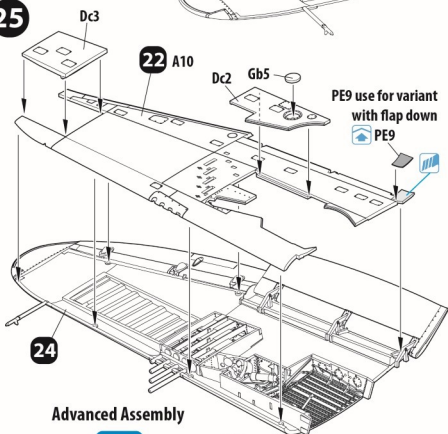
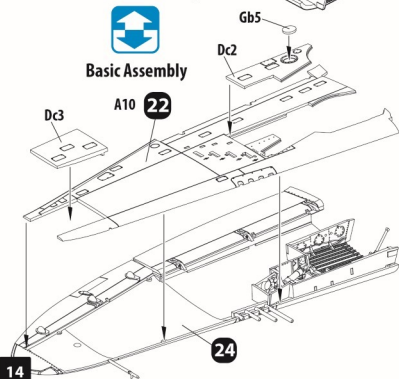
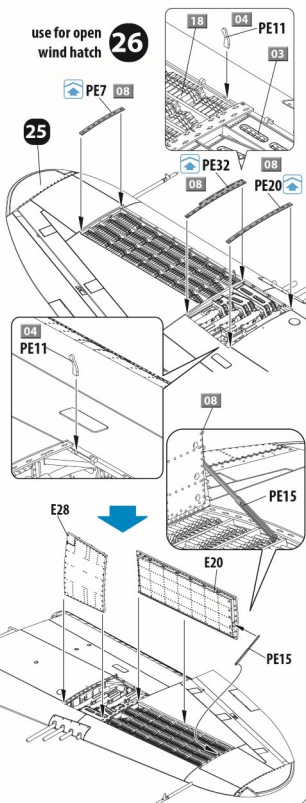

A use for variant with flap down

24**25****Advanced Assembly****Basic Assembly****use for open wind hatch****26****14****24**

27

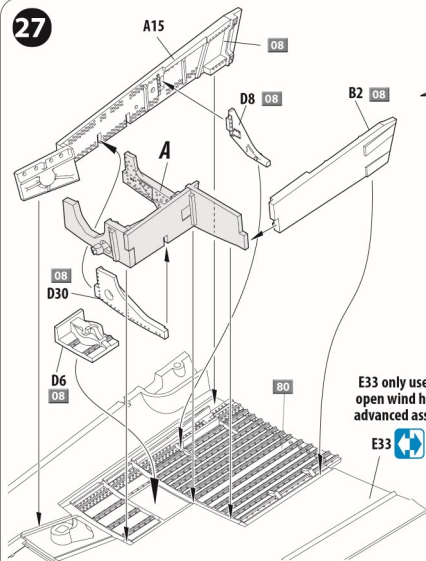

Use only for open hatch on the wind

28

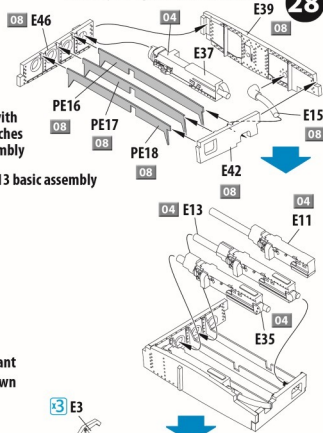
E33 only use with
open wind hatches
advanced assemblyE33  A13 basic assembly

29

B

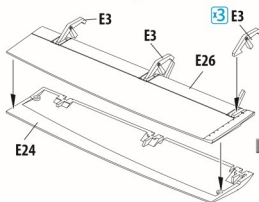
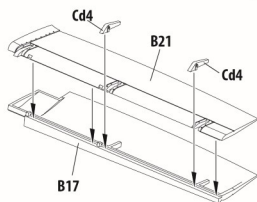
A use for variant
with flap down

30

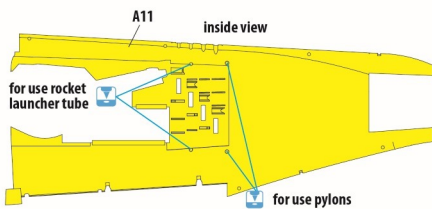

31

Use only for open hatch on the wind

The parts E18 use only for open hatch on the wind

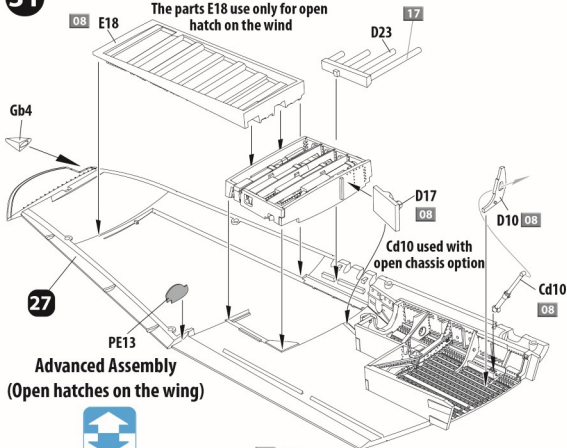

27

Advanced Assembly
(Open hatches on the wing)

Basic Assembly

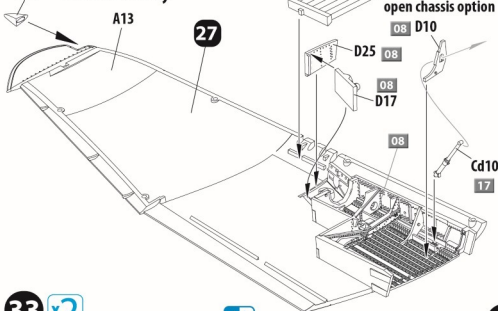

chassis normal

32

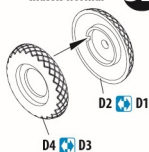

chassis under load

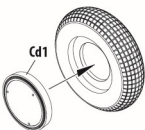
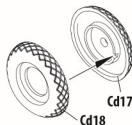

33

x2

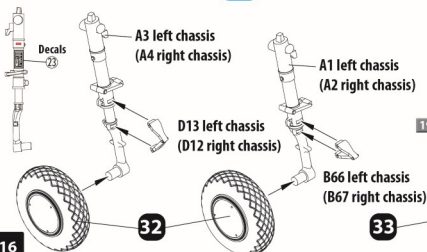
chassis normal  chassis under load

16

32

33

34

x2

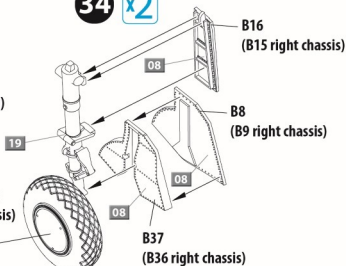

33

use for variant
with flap down

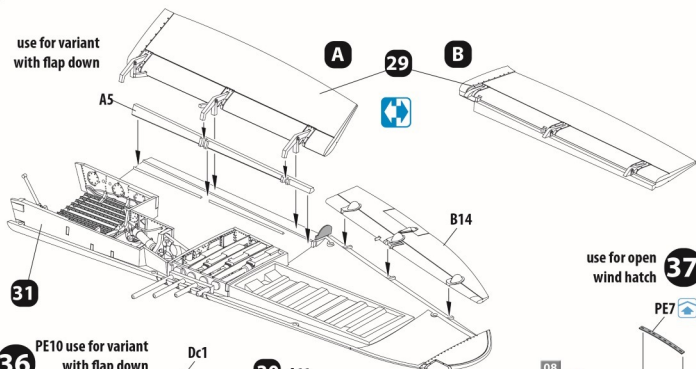

use for open
wind hatch

37

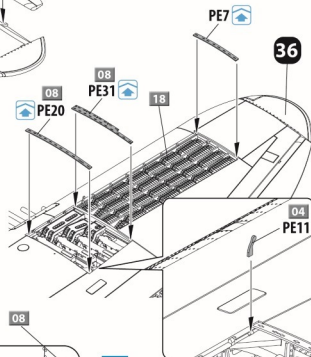
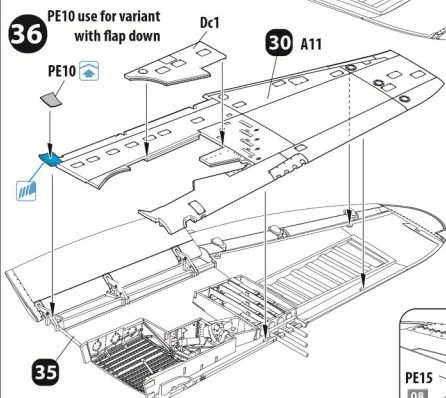

Advanced Assembly



Basic Assembly

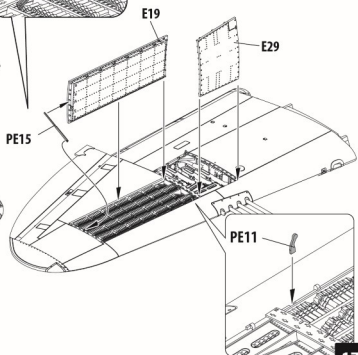
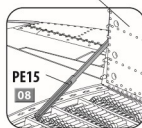
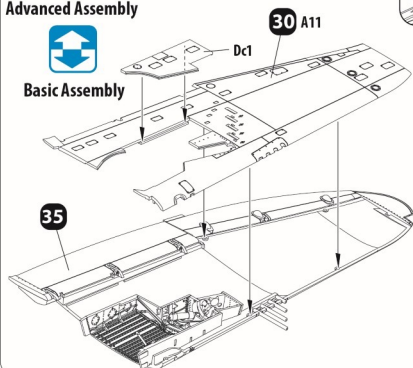

38

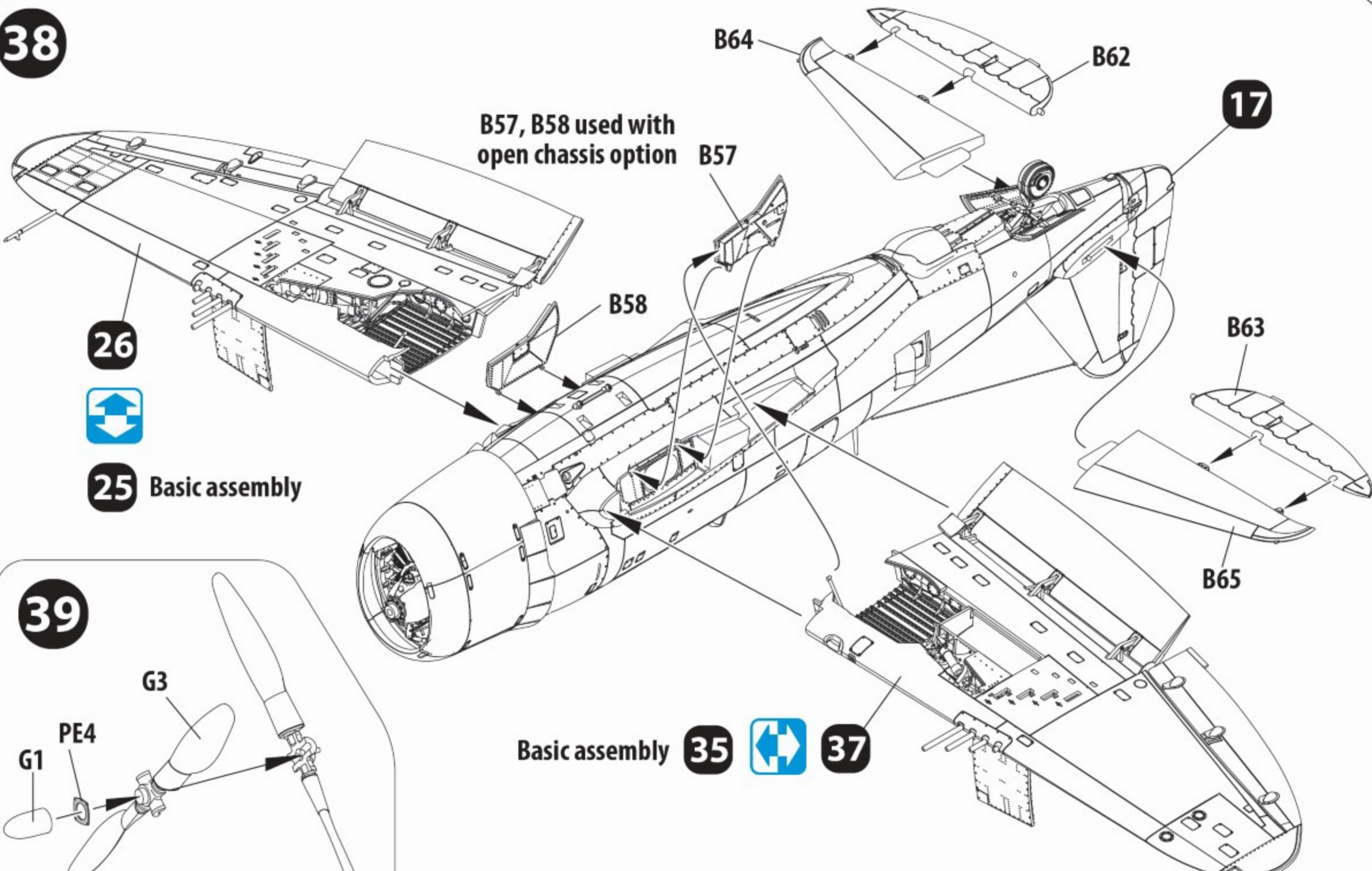

26



25 Basic assembly

39

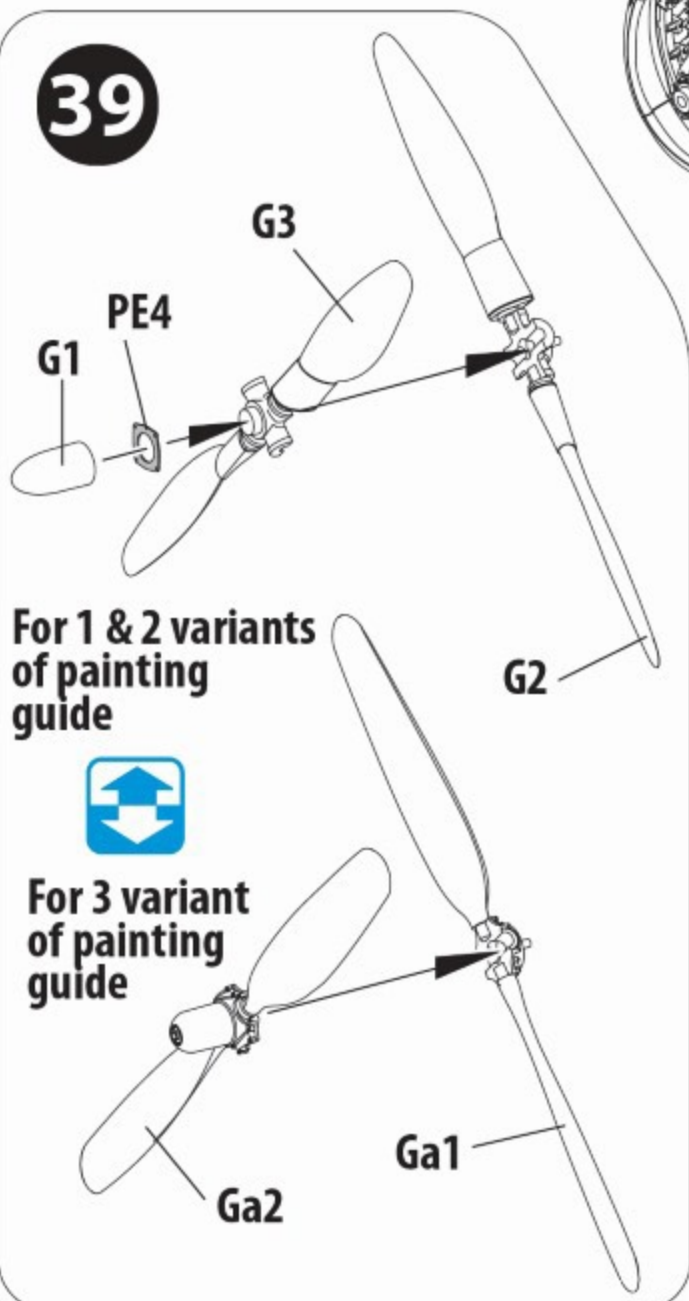

For 1 & 2 variants of painting guide



For 3 variant of painting guide

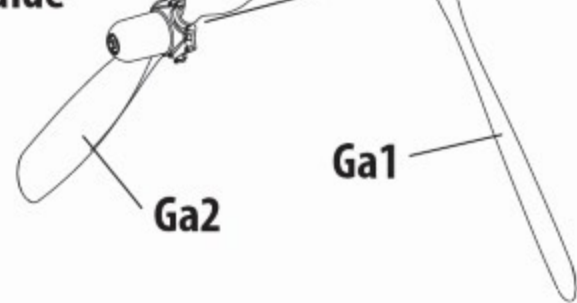

Basic assembly 35 37



B59, B60 used with closed chassis option

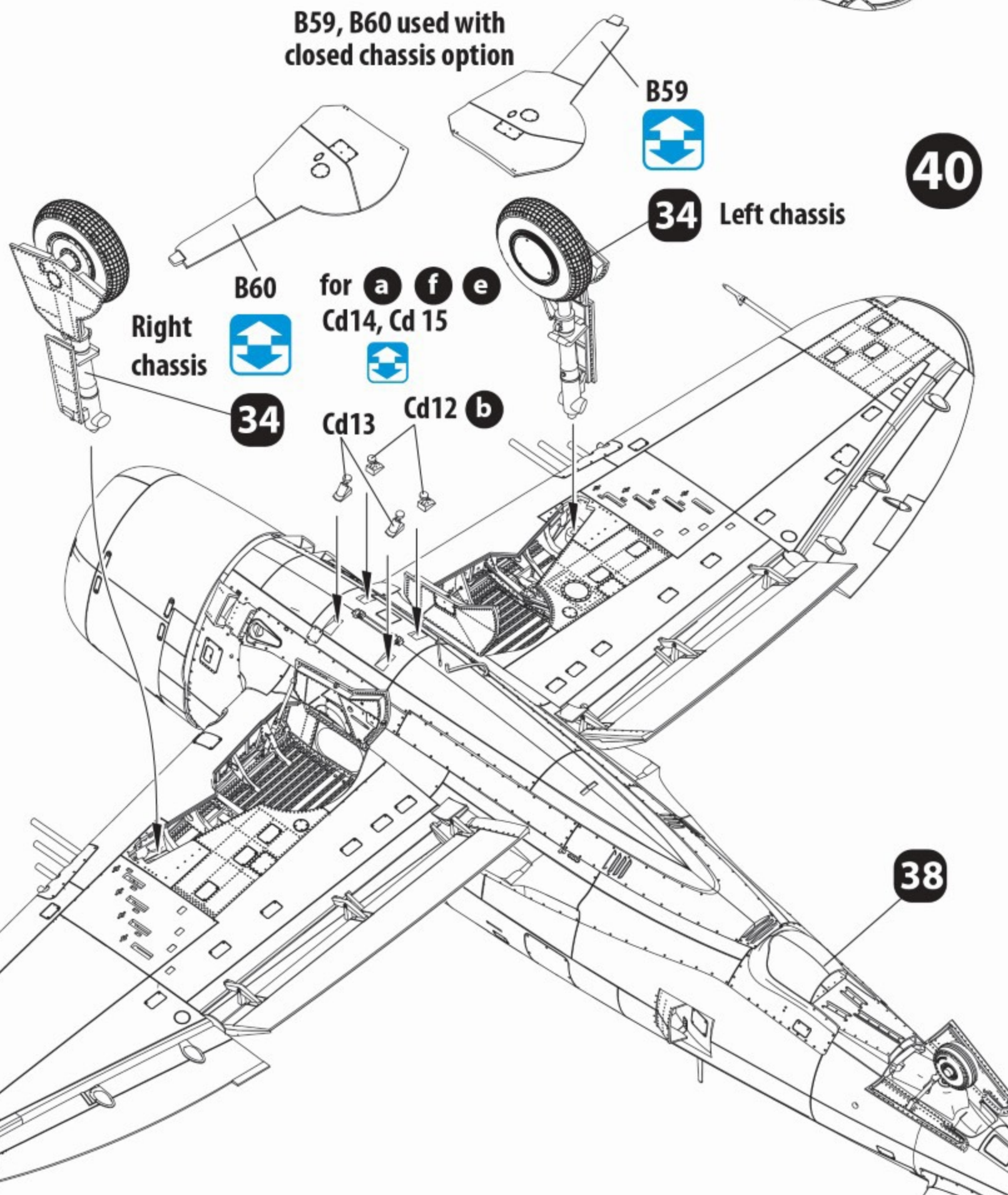

34 Left chassis

40

Right chassis



34

for a f e Cd14, Cd 15



b Cd13 Cd12

Cd10 08 B57 (B58)

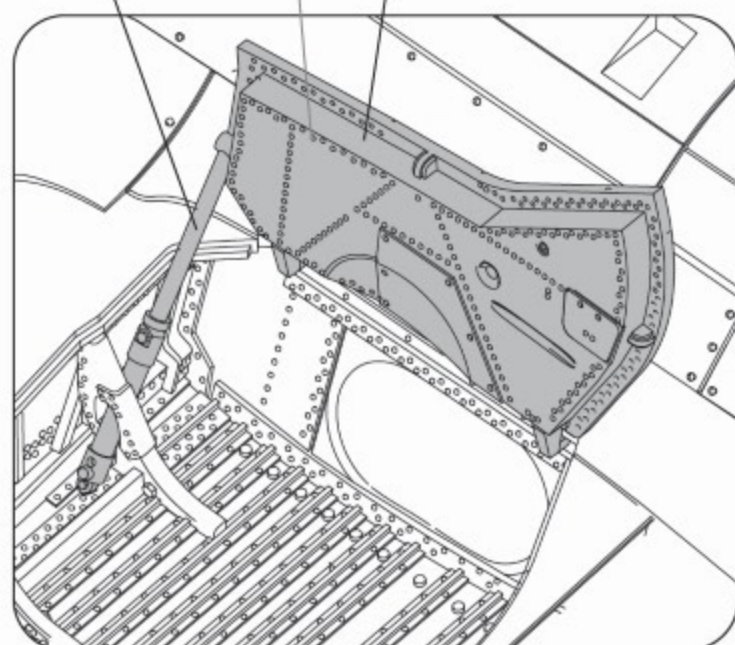

41

39

40

Gb2

A

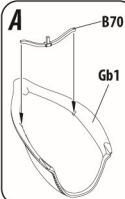
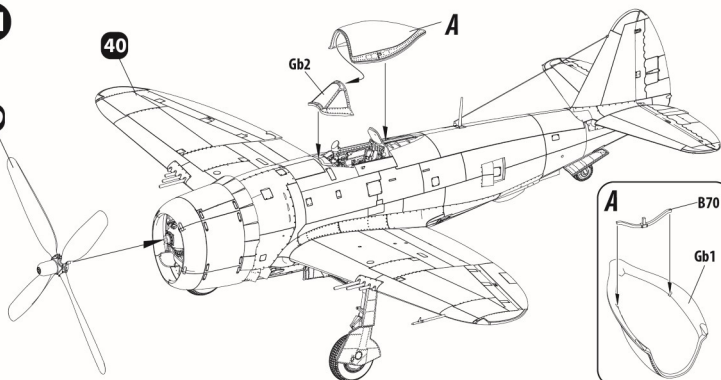

42

PYLON RIGHT

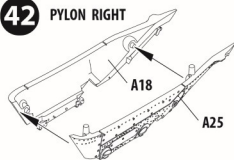

43

PYLON LEFT

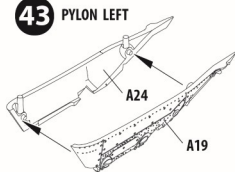

44

EMPTY PYLONS

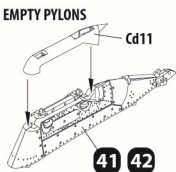

41 42

ARMAMENTS

a

108Gal PAPER DROP TANK

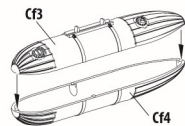
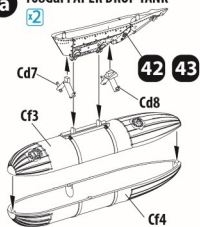

b

200Gal DROP TANK

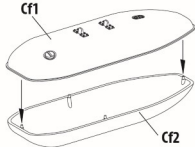
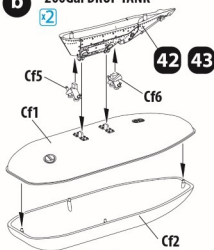

c

150Gal DROP TANK

Can be remove

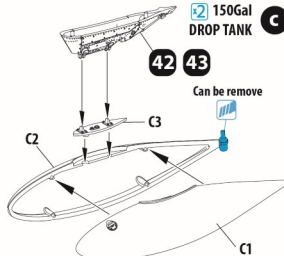

d

75Gal DROP TANK

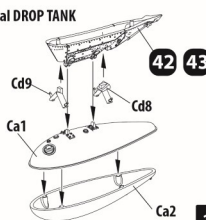

e 1000lb AN-M65 BOMBS

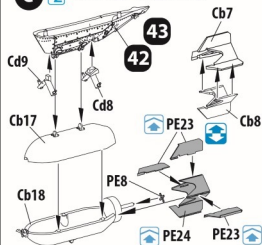

f 1000lb AN-M59 BOMBS

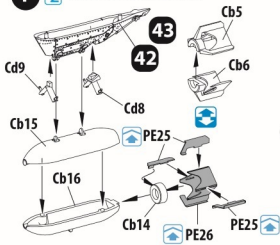

g SMOKE GRENADE

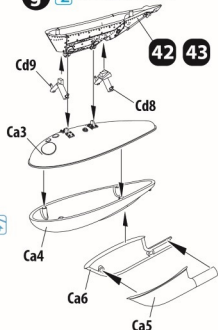

h 250lb AN-M57 BOMBS

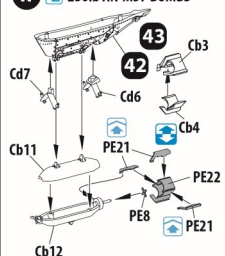

i 500lb AN-M58A1 BOMBS

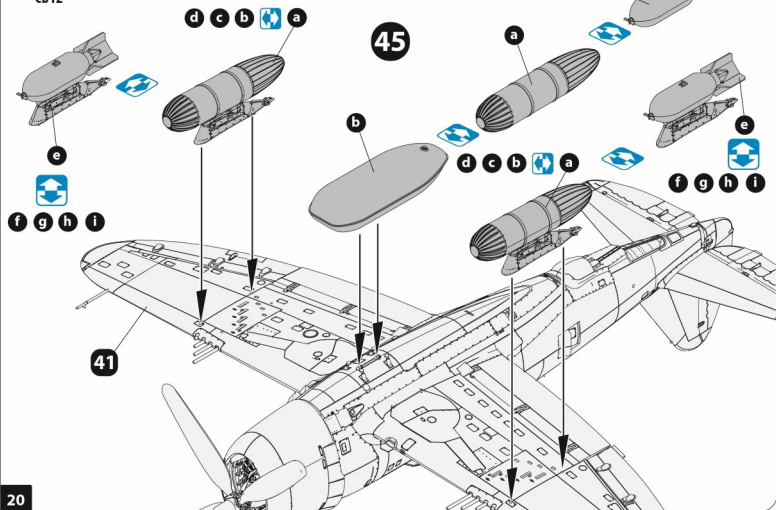
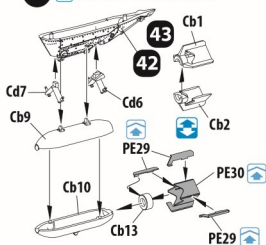

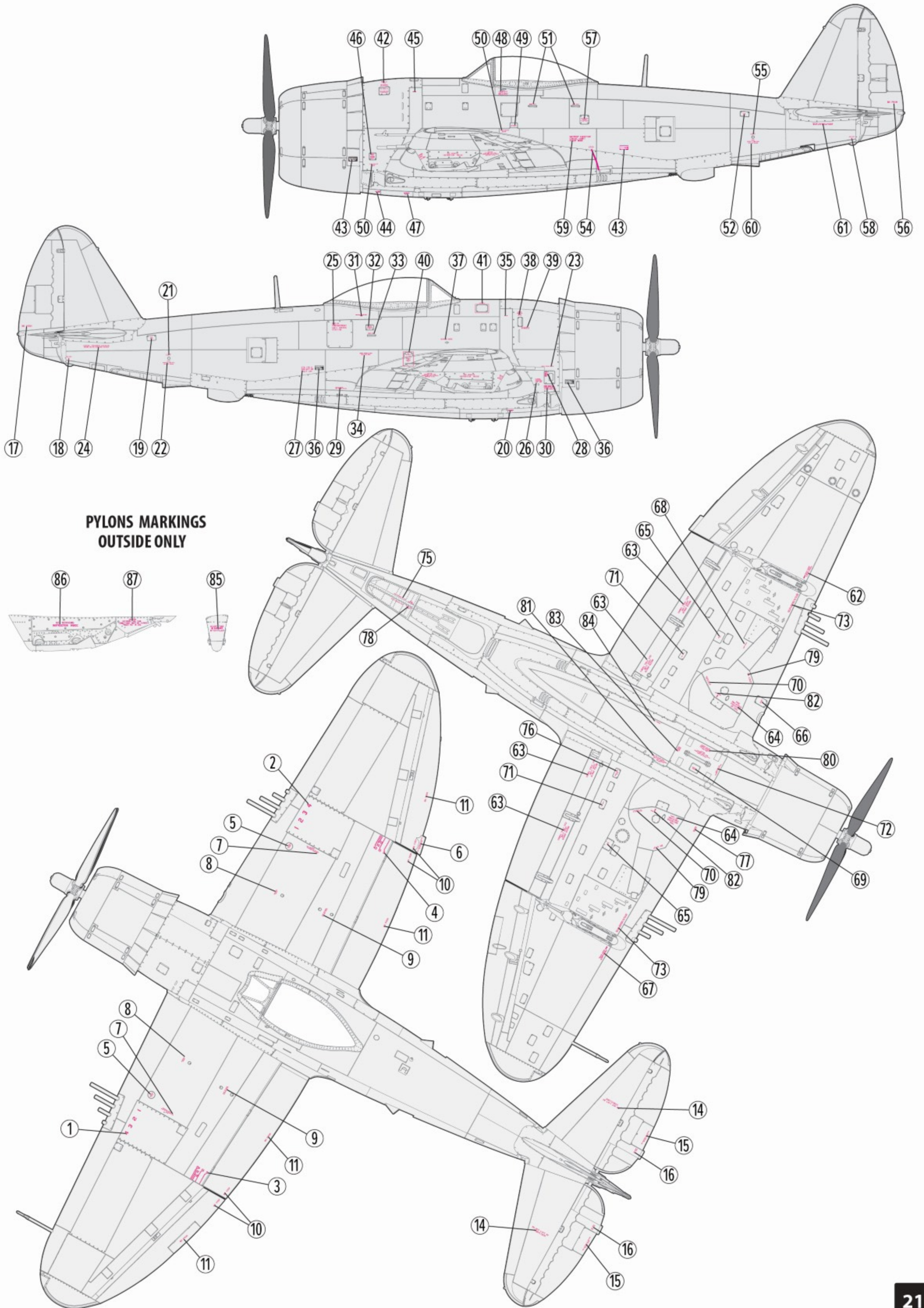

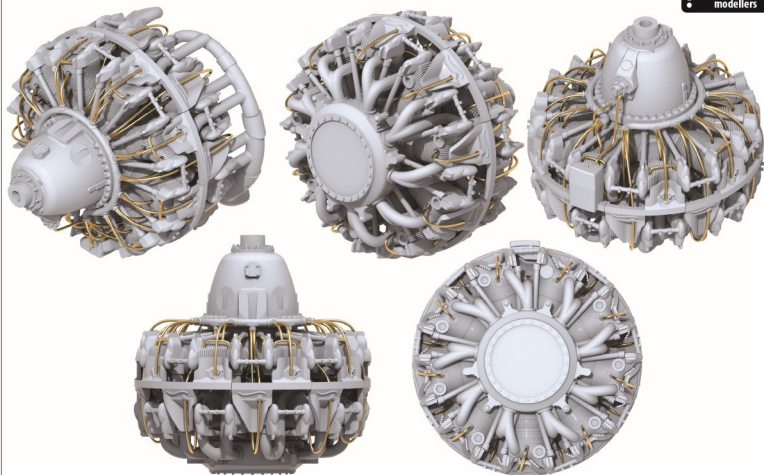

Wiring Diagrams of left Wing

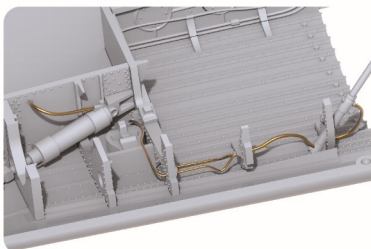

Wiring Diagrams of right Wing

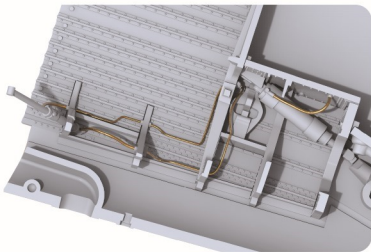
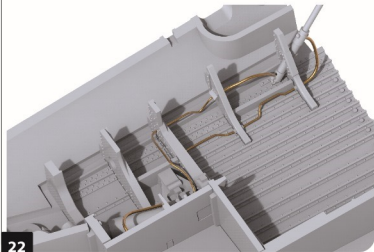

Miniart: 48012

ARMAMENT

ADVANCED KIT

250lb AN-M57 BOMBS



500lb AN-M58A1 BOMBS



1000lb AN-M59 BOMBS



1000lb AN-M65 BOMBS



108Gal PAPER DROP TANK



150Gal DROP TANK



75Gal DROP TANK



200Gal DROP TANK



SMOKE GRENADE



COLOR CHART

No	Color	Valejo	Mt. Color	AK RC	Mission Models	Tamiya	Color name
01		71.137	C-351	RC-262	MMP-059	XF-05	FS 34151 (Interior Green)
02		71.062	C-090	RC-020	MMH-008	XF-16	Aluminum
03		71.306	C-321	RC-018	MMP-039	XF-55	Yellow Gray
04		71.057	C-033	RC-001	MMP-047	XF-01	Black
05		71.077	C-034	RC-002	A.MIG-046	XF-04	Black
06		71.041	C-310	RC-035	A.MIG-078	XF-10	Olive Drab
07		71.003	C-003	RC-006	MMP-003	XF-07	Red
08		71.107	C-352	RC-263	A.MIG-049	XF-07	FS 34817 Zinc Chromate Yellow
09		71.109	C-072	RC-297	MMP-067	XF-18	FS 35154 Intermediate Blue
10		71.325	C-118	RC-304	A.MIG-020	XF-42	FS 34006 (AMA 013) Green Drab
11		71.018	C-079	RC-257	MMP-052	XF-02	Black
12		71.018	C-012	RC-259	A.MIG-025	XF-42	Black
13		71.001	C-082	RC-004	MMP-001	XF-02	FS 29070 Dark Olive Drab
14		71.274	C-013	RC-261	A.MIG-029	XF-20	FS 36122 Neutral Gray
15		71.046	C-603	RC-210	MMP-066	XF-67	FS 34902 Medium Green
16		71.251	C-137	RC-022	MMP-040	XF-19	Light Gray
17		71.097	C-119	RC-300	A.MIG-033	XF-85	Tire Black
18		71.077	C-080	RC-264	MMP-065	XF-17	Black
19		71.072	C-055	AK-476	MMH-002	XF-56	Steel

AIRPLANES SERIES

SCALE 1:48

AIRPLANES SERIES

PLASTIC MODEL KIT THIS IS NOT A TOY
BOX CONTAINS MODEL OF AIRPLANE
3 DECAL OPTIONS

P-47D-28RE THUNDERBOLT

FREE FRENCH AIR FORCE



48015

basickit

SCALE

1:48



P-47D-30RA THUNDERBOLT

ADVANCED KIT



VALLEYVIEW
BOOTH23



48029

PLASTIC MODEL KIT THIS IS NOT A TOY
BOX CONTAINS MODEL OF AIRPLANE
2 DECAL OPTIONS PE PARTS ARE INCLUDED

1:48

AIRPLANES SERIES